

2SNK  
2SN

**2SNK**  
**2SN**



	High Pressure Compact Hose EN 857 2SC - ISO 11237-1 2SC - SAE 100 R16S HOS-2SNK...-A-STM-MSHA	8		JIC 37° Hose Connectors	21 - 23
	High Pressure Hose EN 853 2SN. SAE 1002AT - ISO 1436-1 2SN/2AT HOS-2SN...-A-STM-MSHA	8		Straight Insert with Male UN/UNF Thread and JIC 37° Taper AGJ	21
	Non-Skive Swage Ferrule for Types HOS-2SNK / HOS-2SN HF-1000	9		Straight Insert with Female UN/UNF Thread and JIC 37° Female Conical Bore DKJ	22
	Metric Thread Hose Connectors (Light and Heavy Series)	10 - 17		45° Elbow Insert with Female UN/UNF Thread and JIC 37° Female Conical Bore DKJ 45°	22
	Straight Insert with Male Metric Thread and 24° Conical Bore CEL (Light Series)	10		90° Elbow Insert with Female UN/UNF Thread and JIC 37° Female Conical Bore DKJ 90°	23
	Straight Insert with Male Metric Thread and 24° Conical Bore CES (Heavy Series)	11		ORFS Hose Connectors	23 - 24
	Straight Insert with Female Metric Nut Thread and 24° Taper / O-Ring DKOL (Light Series)	12		Straight Insert with Female UN/UNF Thread for O-Ring Face Seal Connection ORS	23
	Straight Insert with Female Metric Nut Thread and 24° Taper / O-Ring DKOS (Heavy Series)	13		45° Elbow Insert with Female UN/UNF Thread for O-Ring Face Seal Connection ORS 45°	24
	45° Elbow Insert with Female Metric Nut Thread and 24° Taper / O-Ring DKOL 45° (Light Series)	14		90° Elbow Insert with Female UN/UNF Thread for O-Ring Face Seal Connection ORS 90°	24
	45° Elbow Insert with Female Metric Nut Thread and 24° Taper / O-Ring DKOS 45° (Heavy Series)	15		SAE Code 61 & Code 62 Hose Connectors (3000 PSI and 6000 Series)	25 - 30
	90° Elbow Insert with Female Metric Nut Thread and 24° Taper / O-Ring DKOL 90° (Light Series)	16		Straight Insert with SAE Flange Adaptor SFL (3000 PSI Series)	25
	90° Elbow Insert with Female Metric Nut Thread and 24° Taper / O-Ring DKOS 90° (Heavy Series)	17		Straight Insert with SAE Flange Adaptor SFS (6000 PSI Series)	26
	BSPP Thread Hose Connectors	18 - 20		45° Elbow Insert with SAE Flange Adaptor SFL 45° (3000 PSI Series)	27
	Straight Insert with Male BSPP Thread and 60° Conical Bore AGR	18		45° Elbow Insert with SAE Flange Adaptor SFS 45° (6000 PSI Series)	28
	Straight Insert with Female BSPP Thread and 60° Taper DKR	19		90° Elbow Insert with SAE Flange Adaptor SFL 90° (3000 PSI Series)	29
	45° Elbow Insert with Female BSPP Thread and 60° Taper DKR 45°	19		90° Elbow Insert with SAE Flange Adaptor SFS 90° (6000 PSI Series)	30
	90° Elbow Insert with Female BSPP Thread and 60° Taper DKR 90°	20		Hose Assemblies for Types HOS-2SNK / HOS-2SN Order Codes - Same Fitting Type and Connection Size	31
				Hose Assemblies for Types HOS-2SNK / HOS-2SN Order Codes - Different Fitting Type or/and Connection Size	32 - 33



## High Pressure Compact Hose

### EN 857 2SC - ISO 11237-1 2SC - SAE 100 R16S

#### Type HOS-2SNK-...-A-STM-MSHA

2SNK  
2SN

#### Product Description

Compact hose construction for medium to high pressure at reduced bend radii. Suitable for conveying petroleum based hydraulic fluids, synthetic esters, biodegradable hydraulic fluids, water glycol based fluids and air.



#### Technical Features

<b>Tube Material</b>	Synthetic rubber, resistant against hydraulic fluids (HL, HLP, HLPD, HVLP, HFA, HFAS, HFB, HFC)
<b>Reinforcement</b>	Two braids of high tensile steel wire
<b>Hose Cover Material</b>	Abrasion and ozone resistant synthetic rubber MSHA Approved IC-08/24
<b>Working Temperature</b>	-40°C to 100°C / -40°F to +212°F (max 120°C / 248°F intermittent)
<b>Testing</b>	Impulse tested up to 1 million cycles (tested acc. to ISO6803:2017 / DN31 tested up to 200.000 cycles)

Item No.	Designation	ID				OD		Working Pressure		Burst Pressure bar	Bend Radius mm	Weight Kg/m	Crimp Dia <sup>1</sup> mm
		DN	Dash	Inch	mm	Wire OD mm	Cover OD mm	bar	PSI				
6100297373	HOS-2SNK-06-A-STM-MSHA	06	-04	1/4	6.6	11.5	13.4	450	6525	1800	45	0.27	16.3
6100297372	HOS-2SNK-10-A-STM-MSHA	10	-06	3/8	9.9	14.7	16.8	385	5585	1540	65	0.38	20.9
6100297371	HOS-2SNK-12-A-STM-MSHA	12	-08	1/2	13.0	18.4	20.5	350	5075	1400	90	0.52	24.6
6100297370	HOS-2SNK-16-A-STM-MSHA	16	-10	5/8	16.4	21.9	23.7	290	4205	1160	100	0.61	28.5
6100297369	HOS-2SNK-19-A-STM-MSHA	19	-12	3/4	19.5	26.0	27.7	280	4060	1120	120	0.79	31.7
6100297374	HOS-2SNK-25-A-STM-MSHA	25	-16	1	26.0	32.9	35.6	200	2900	800	150	1.15	40.4
6100297367	HOS-2SNK-31-A-STM-MSHA	31	-20	1-1/4	32.5	40.5	43.5	175	2540	700	300	1.57	47.1

<sup>1</sup> Crimp Diameter is for reference only, more information in Swaging Guide on Page 102.

Supply of loose hose in bulk on PVC 20" and 28" reels available on request. Contact STAUFF for more information.

## High Pressure Hose

### EN 853 2SN. SAE 1002AT - ISO 1436-1 2SN/2AT

#### Type HOS-2SN-...-A-STM-MSHA



#### Product Description

Medium to high pressure hydraulic lines. Suitable for conveying petroleum based hydraulic fluids, synthetic esters, biodegradable hydraulic fluids, water glycol based fluids and air. Beware when using hoses for air or inert gases, hose cover requires to be pricked to allow gas permeation and venting to the atmosphere.



#### Technical Features

<b>Tube Material</b>	Synthetic rubber, resistant against hydraulic fluids (HL, HLP, HLPD, HVLP, HFA, HFAS, HFB, HFC)
<b>Reinforcement</b>	Two braids of high tensile steel wire
<b>Hose Cover Material</b>	Abrasion and ozone resistant synthetic rubber MSHA Approved IC-08/24
<b>Working Temperature</b>	-40°C to 100°C / -40°F to +212°F (max 120°C / 248°F intermittent)

Item No.	Designation	ID				OD		Working Pressure		Burst Pressure bar	Bend Radius mm	Weight Kg/m	Crimp Dia <sup>1</sup> mm
		DN	Dash	Inch	mm	Wire OD mm	Cover OD mm	bar	PSI				
6100297366	HOS-2SN-38-A-STM-MSHA	38	-24	1-1/2	38.7	51.1	54.5	90	1305	360	500	2.12	58.9
6100297365	HOS-2SN-51-A-STM-MSHA	51	-32	2	51.1	62.9	66.7	80	1160	320	630	2.79	71.3

<sup>1</sup> Crimp Diameter is for reference only, more information in Swaging Guide on Page 102.

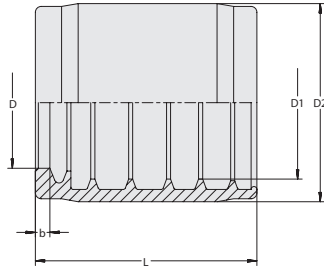

**Non-Skive Swage Ferrule for Types HOS-2SNK / 2SN  
Series 1000**

**Technical Features**

Suitable Hose Type	▲ 2SNK / ● 2SN
Standards	EN 857 / EN 853
Material	Carbon Steel
Surface Finishing	Zinc/Nickel-Plating
Working Pressure	Maximum working pressures depending on type of hose connector and hose type.



Item No.	Designation	Hose Size			Hose Type	Dimensions (mm/in)					Weight (kg/lbs) ca. per 100
		DN	Inch	Dash		D	D1	D2	L	b	
2012031318	HF-1000-06-W3	06	1/4	-04	▲	11.8	15.7	21.0	31.0	2.5	2.6
						.46	.62	.83	1.22	.10	5.62
2012031319	HF-1000-10-W3	10	3/8	-06	▲	15.5	19.8	26.5	33.0	2.5	4.7
						.61	.78	1.04	1.30	.10	10.25
2012031320	HF-1000-12-W3	12	1/2	-08	▲	19.2	23.0	30.0	36.0	2.5	5.7
						.76	.91	1.18	1.42	.10	12.57
6100060738	HF-1000-16-W3	16	5/8	-10	▲	22.5	26.2	34.0	38.0	2.5	7.8
						.89	1.03	1.34	1.50	.10	17.09
2012031321	HF-1000-19-W3	19	3/4	-12	▲	25.5	30.1	38.0	44.0	3.0	10.4
						1.00	1.19	1.50	1.73	.12	22.82
2012031442	HF-1000-25-W3	25	1	-16	▲	32.8	38.8	47.0	52.0	3.7	16.4
						1.29	1.53	1.85	2.05	.15	36.16
2012032237	HF-1000-31-W3	31	1-1/4	-20	▲	40.5	49.3	57.0	60.0	4.0	21.1
						1.59	1.94	2.24	2.36	.16	46.53
6100030769	HF-1000-38-W3	38	1-1/2	-24	●	46.6	55.8	65.0	73.0	4.3	37.5
						1.83	2.20	2.56	2.87	.17	82.58
6100060740	HF-1000-51-W3	51	2	-32	●	58.9	68.5	78.0	80.0	4.3	50.0
						2.32	2.70	3.07	3.15	.17	110.25



**Straight Insert with Male Metric Thread and 24° Conical Bore  
Type CE-..L (Light Series)**

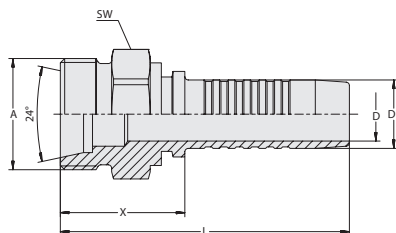

**Technical Features**

Suitable Hose Type	▲ 2SNK / ● 2SN
Connection Type	Male Metric Thread
Sealing Type	24° Conical Bore (Shape W acc. to DIN 3861)
Standard	ISO 8434-1
Material	Carbon Steel
Surface Finishing	Zinc/Nickel-Plating

Item No.	Designation	Hose Size			Connection Size		Hose Type	Working Pressure (bar/PSI)	Dimensions (mm/in)					Weight (%/lbs) ca. per 100
		DN	Inch	Dash	Thread	Dash			D	D1	X	L	SW (Hex)	
6100096898	HCS-06-CE-06L-M-W3	06	1/4	-04	M12x1.5	-03	▲	450	3.9	6.7	23.5	53.5	14	2.2
								6527	.15	.26	.93	2.11	.55	4.85
6100096900	HCS-06-CE-08L-M-W3	06	1/4	-04	M14x1.5	-04	▲	450	3.9	6.7	23.5	53.5	14	2.3
								6527	.15	.26	.93	2.11	.55	5.07
6100095477	HCS-06-CE-10L-M-W3	06	1/4	-04	M16x1.5	-05	▲	450	3.9	6.7	25.5	55.5	17	3.1
								6527	.15	.26	1.00	2.19	.67	6.73
6100095482	HCS-06-CE-12L-M-W3	06	1/4	-04	M18x1.5	-06	▲	450	3.9	6.7	25.5	55.5	19.0	3.4
								6527	.15	.26	1.00	2.19	.75	7.50
6100095791	HCS-10-CE-10L-M-W3	10	3/8	-06	M16x1.5	-05	▲	385	6.5	9.9	24.5	58.0	17.0	3.7
								5584	.26	.39	.96	2.28	.67	8.05
6100095793	HCS-10-CE-12L-M-W3	10	3/8	-06	M18x1.5	-06	▲	385	6.5	9.9	25.5	59.0	19.0	4.1
								5584	.26	.39	1.00	2.32	.75	9.04
6100095799	HCS-10-CE-15L-M-W3	10	3/8	-06	M22x1.5	-08	▲	385	6.5	9.9	27.5	61.0	22.0	5.8
								5584	.26	.39	1.08	2.40	.87	12.79
6100095972	HCS-12-CE-12L-M-W3	12	1/2	-08	M18x1.5	-06	▲	350	9.5	13.0	26.5	62.0	19.0	5.1
								5076	.37	.51	1.04	2.44	.75	11.14
6100095977	HCS-12-CE-15L-M-W3	12	1/2	-08	M22x1.5	-08	▲	350	9.5	13.0	28.0	63.5	22.0	6.6
								5076	.37	.51	1.10	2.50	.87	14.55
6100095982	HCS-12-CE-18L-M-W3	12	1/2	-08	M26x1.5	-10	▲	350	9.5	13.0	29.5	65.0	27.0	9.1
								5076	.37	.51	1.16	2.56	1.06	19.96
6100096164	HCS-16-CE-18L-M-W3	16	5/8	-10	M26x1.5	-10	▲	290	12.6	16.0	29.0	67.5	27.0	9.3
								4206	.50	.63	1.14	2.66	1.06	20.51
6100096333	HCS-19-CE-22L-M-W3	19	3/4	-12	M30x2	-12	▲	280	14.8	19.1	32.5	78.5	30.0	13.2
								4061	.58	.75	1.28	3.09	1.18	29.00
6100096502	HCS-25-CE-28L-M-W3	25	1	-16	M36x2	-16	▲	200	20.0	25.9	34.5	89.5	36.0	23.0
								2901	.79	1.02	1.36	3.52	1.42	50.60
6100096642	HCS-31-CE-35L-M-W3	31	1-1/4	-20	M45x2	-20	▲	175	26.0	32.5	39.5	99.5	46.0	38.5
								2538	1.02	1.28	1.56	3.92	1.81	84.89
6100056713	HCS-38-CE-42L-M-W3	38	1-1/2	-24	M52x2	-24	●	100	31.0	38.9	42.5	110.0	55.0	58.3
								1450	1.22	1.53	1.67	4.33	2.17	128.44

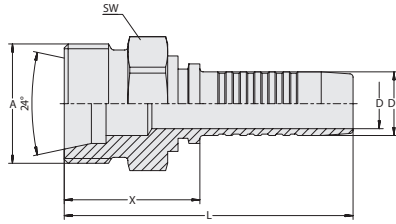

**Straight Insert with Male Metric Thread and 24° Conical Bore  
Type CE-..S (Heavy Series)**

**Technical Features**

Suitable Hose Type	▲ 2SNK
Connection Type	Male Metric Thread
Sealing Type	24° Conical Bore (Shape W acc. to DIN 3861)
Standard	ISO 8434-1
Material	Carbon Steel
Surface Finishing	Zinc/Nickel-Plating



Item No.	Designation	Hose Size			Connection Size		Hose Type	Working Pressure ( <sup>bar</sup> / <sub>PSI</sub> )	Dimensions (mm/in)					Weight ( <sup>kg</sup> / <sub>lbs</sub> ) ca. per 100
		DN	Inch	Dash	Thread	Dash			D	D1	X	L	SW (Hex)	
6100096902	HCS-06-CE-08S-M-W3	06	1/4	-04	M16x1.5	-03	▲	630	3.9	6.7	25.5	55.5	17	3.3
								9135	.15	.26	1.00	2.19	.67	7.28
6100095479	HCS-06-CE-10S-M-W3	06	1/4	-04	M18x1.5	-04	▲	630	3.9	6.7	26.5	56.5	19	4.0
								9135	.15	.26	1.04	2.22	.75	8.82
6100095794	HCS-10-CE-12S-M-W3	10	3/8	-06	M20x1.5	-05	▲	630	6.5	9.9	27.5	61.0	22.0	5.9
								9135	.26	.39	1.08	2.40	.87	13.01
6100095796	HCS-10-CE-14S-M-W3	10	3/8	-06	M22x1.5	-06	▲	630	6.5	9.9	29.5	63.0	22.0	6.5
								9135	.26	.39	1.16	2.48	.87	14.22
6100095974	HCS-12-CE-12S-M-W3	12	1/2	-08	M20x1.5	-05	▲	450	9.5	13.0	28.0	63.5	22.0	6.6
								6527	.37	.51	1.10	2.50	.87	14.44
6100095975	HCS-12-CE-14S-M-W3	12	1/2	-08	M22x1.5	-06	▲	450	9.5	13.0	30.0	65.5	22.0	7.3
								6527	.37	.51	1.18	2.58	.87	16.10
6100095980	HCS-12-CE-16S-M-W3	12	1/2	-08	M24x1.5	-08	▲	450	9.5	13.0	30.0	65.5	24.0	8.0
								6527	.37	.51	1.18	2.58	.94	17.53
6100095984	HCS-12-CE-20S-M-W3	12	1/2	-08	M30x2	-10	▲	450	9.5	13.0	34.0	70w.0	30.0	13.1
								6527	.37	.51	1.34	2.76	1.18	28.89
6100096165	HCS-16-CE-20S-M-W3	16	5/8	-10	M30x2	-10	▲	420	12.6	16.0	34.0	72.5	30.0	12.9
								6092	.50	.63	1.34	2.85	1.18	28.33
6100096167	HCS-16-CE-25S-M-W3	16	5/8	-10	M36x2	-12	▲	420	12.6	16.0	37.0	75.5	36.0	19.7
								6092	.50	.63	1.46	2.97	1.42	43.44
6100096328	HCS-19-CE-20S-M-W3	19	3/4	-12	M30x2	-10	▲	420	14.8	19.1	34.5	80.5	30.0	14.8
								6092	.58	.75	1.36	3.17	1.18	32.63
6100096335	HCS-19-CE-25S-M-W3	19	3/4	-12	M36x2	-12	▲	420	14.8	19.1	37.5	83.5	36.0	20.4
								6092	.58	.75	1.48	3.29	1.42	44.87
6100096499	HCS-25-CE-25S-M-W3	25	1	-16	M36x2	-12	▲	420	20.0	25.9	38.5	93.5	36.0	25.5
								6092	.79	1.02	1.52	3.68	1.42	56.23
6100096504	HCS-25-CE-30S-M-W3	25	1	-16	M42x2	-16	▲	420	20.0	25.9	42.5	97.5	46.0	36.4
								6092	.79	1.02	1.67	3.84	1.81	80.26
6100096506	HCS-25-CE-38S-M-W3	25	1	-16	M52x2	-20	▲	420	20.0	25.9	46.5	101.5	55.0	55.7
								6092	.79	1.02	1.83	4.00	2.17	122.71
6100096644	HCS-31-CE-38S-M-W3	31	1-1/4	-20	M52x2	-20	▲	420	26.0	32.5	47.5	107.5	55.0	57.30
								6092	1.02	1.28	1.87	4.23	2.17	126.35





### Straight Insert with Female Metric Nut Thread and 24° Taper / O-Ring Type DKO-..L (Light Series)

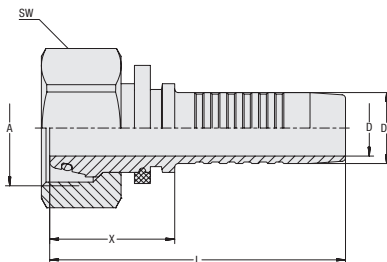

#### Technical Features

Suitable Hose Type	▲ 2SNK / ● 2SN
Connection Type	Female Metric Nut Thread
Sealing Type	24° Taper with O-Ring
Standard	ISO 8434-1
Material	Carbon Steel
Surface Finishing	Zinc/Nickel-Plating
Sealing Material	NBR (Buna-N®)

Item No.	Designation	Hose Size			Connection Size		Hose Type	Working Pressure (bar/PSI)	Dimensions (mm/in)				Weight (kg/lbs) ca. per 100	
		DN	Inch	Dash	Thread	Dash			D	D1	X	L		SW (Hex)
6100096922	HCS-06-DKO-06L-W-OR-B-M-W3	06	1/4	-04	M12x1.5	-03	▲	450 6527	3.9 .15	6.7 .26	21.0 .83	51.0 2.01	14.0 .55	2.3 5.07
6100096923	HCS-06-DKO-06L-W-OR-B-M-W3-SW17	06	1/4	-04	M12x1.5	-03	▲	450 6527	3.9 .15	6.7 .26	21.0 .83	51.0 2.01	17.0 .67	3.2 7.06
6100060504	HCS-06-DKO-08L-S-OR-B-M-W3	06	1/4	-04	M14x1.5	-04	▲	450 6527	3.9 .15	6.7 .26	24.5 .96	54.0 2.13	17.0 .67	3.3 7.17
6100060505	HCS-06-DKO-10L-S-OR-B-M-W3	06	1/4	-04	M16x1.5	-05	▲	450 6527	3.9 .15	6.7 .26	26.0 1.02	55.5 2.19	19.0 .75	4.0 8.82
6100044174	HCS-06-DKO-12L-S-OR-B-M-W3	06	1/4	-04	M18x1.5	-08	▲	450 6527	3.9 .15	6.7 .26	29.0 1.14	59.0 2.32	22.0 .87	5.3 11.69
6100095840	HCS-10-DKO-10L-W-OR-B-M-W3	10	3/8	-06	M16x1.5	-05	▲	385 5584	6.5 .26	9.9 .39	22.5 .89	56.0 2.20	19.0 .75	4.6 10.14
6100058583	HCS-10-DKO-12L-S-OR-B-M-W3	10	3/8	-06	M18x1.5	-06	▲	385 5584	6.5 .26	9.9 .39	26.0 1.02	59.0 2.32	22.0 .87	6.0 13.12
6100011097	HCS-10-DKO-15L-S-OR-B-M-W3	10	3/8	-06	M22x1.5	-08	▲	385 5584	6.5 .26	9.9 .39	25.0 .98	58.5 2.30	27.0 1.06	8.7 19.18
2012031459	HCS-12-DKO-12L-W-OR-B-M-W3	12	1/2	-08	M18x1.5	-06	▲	350 5076	9.5 .37	13.0 .51	24.0 .94	59.5 2.34	22.0 .87	6.50 14.33
6100058580	HCS-12-DKO-15L-S-OR-B-M-W3	12	1/2	-08	M22x1.5	-08	▲	350 5076	9.5 .37	13.0 .51	25.5 1.00	61.0 2.40	27.0 1.06	8.9 19.51
6100060507	HCS-12-DKO-18L-S-OR-B-M-W3	12	1/2	-08	M26x1.5	-10	▲	350 5076	9.5 .37	13.0 .51	34.5 1.36	70.0 2.76	32.0 1.26	13.15 29.00
6100096192	HCS-16-DKO-15L-S-OR-B-B-W3	16	5/8	-10	M22x1.5	-08	▲	290 4206	12.6 .50	16.0 .63	44.5 1.75	83.0 3.27	27.0 1.06	13.8 30.43
6100058579	HCS-16-DKO-18L-S-OR-B-M-W3	16	5/8	-10	M26x1.5	-10	▲	290 4206	12.6 .50	16.0 .63	28.0 1.10	66.5 2.62	32.0 1.26	12.5 27.56
6100096222	HCS-16-DKO-22L-S-OR-B-M-W3	16	5/8	-10	M30x2	-12	▲	290 4206	12.6 .50	16.0 .63	34.5 1.36	73.0 2.87	36.0 1.42	17.1 37.71
6100096365	HCS-19-DKO-18L-W-OR-B-M-W3	19	3/4	-12	M26x1.5	-10	▲	280 4061	14.8 .58	19.1 .75	25.5 1.00	71.5 2.81	32.0 1.26	14.4 31.64
6100060509	HCS-19-DKO-22L-S-OR-B-M-W3	19	3/4	-12	M30x2	-12	▲	280 4061	14.8 .58	19.1 .75	30.0 1.18	76.0 2.99	36.0 1.42	18.4 40.57
6100096396	HCS-19-DKO-28L-S-OR-B-M-W3	19	3/4	-12	M36x2	-16	▲	280 4061	14.8 .58	19.1 .75	34.0 1.34	78.0 3.07	41.0 1.61	25.0 55.13
6100096529	HCS-25-DKO-22L-S-OR-B-B-W3	25	1	-16	M30x2	-12	▲	200 2901	20.0 .79	25.9 1.02	45.0 1.77	100.0 3.94	36.0 1.42	32.7 72.10
6100049574	HCS-25-DKO-28L-S-OR-B-M-W3	25	1	-16	M36x2	-16	▲	200 2901	20.0 .79	25.9 1.02	33.0 1.30	88.0 3.46	41.0 1.61	28.0 61.74
6100096558	HCS-25-DKO-35L-S-OR-B-M-W3	25	1	-16	M45x2	-20	▲	200 2901	20.0 .79	25.9 1.02	36.0 1.42	91.0 3.58	50.0 1.97	42.2 92.94
6100096672	HCS-31-DKO-28L-S-OR-B-B-W3	31	1-1/4	-20	M30x2	-16	▲	175 2538	26.0 1.02	32.5 1.28	47.5 1.87	107.5 4.23	50.0 1.97	47.3 104.30
2012032256	HCS-31-DKO-35L-S-OR-B-M-W3	31	1-1/4	-20	M45x2	-20	▲	175 2538	26.0 1.02	32.5 1.28	37.0 1.46	97.0 3.82	50.0 1.97	43.8 96.47
6100096698	HCS-31-DKO-42L-S-OR-B-B-W3	31	1-1/4	-20	M52x2	-24	▲	175 2538	26.0 1.02	32.5 1.28	55.0 2.17	115.0 4.53	60.0 2.36	73.8 162.73
6100096777	HCS-38-DKO-35L-S-OR-B-B-W3	38	1-1/2	-24	M45x2	-20	●	100 1450	31.0 1.22	38.9 1.53	56.0 2.20	123.5 4.86	50.0 1.97	71.5 157.66
2012031573	HCS-38-DKO-42L-S-OR-B-M-W3	38	1-1/2	-24	M52x2	-24	●	100 1450	31.0 1.22	38.9 1.53	35.5 1.40	103.0 4.06	60.0 2.36	66.0 145.53

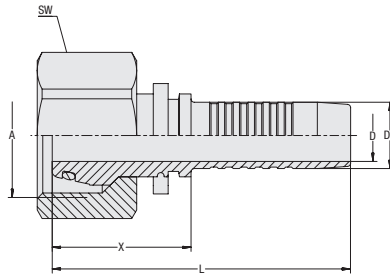

**Straight Insert with Female Metric Nut Thread and 24° Taper / O-Ring  
Type DKO-..S (Heavy Series)**

**Technical Features**

Suitable Hose Type	▲ 2SNK
Connection Type	Female Metric Nut Thread
Sealing Type	24° Taper with O-Ring
Standard	ISO 8434-1
Material	Carbon Steel
Surface Finishing	Zinc/Nickel-Plating
Sealing Material	NBR (Buna-N®)



Item No.	Designation	Hose Size			Connection Size		Hose Type	Working Pressure (bar/PSI)	Dimensions (mm/in)					Weight (kg/lbs) ca. per 100
		DN	Inch	Dash	Thread	Dash			D	D1	X	L	SW (Hex)	
6100096927	HCS-06-DKO-06S-W-OR-B-M-W3	06	1/4	-04	M14x1.5	-02	▲	630	3.9	6.7	26.0	56.0	17.0	3.5
								9135	.15	.26	1.02	2.20	.67	7.72
6100096945	HCS-06-DKO-08S-S-OR-B-M-W3	06	1/4	-04	M16x1.5	-03	▲	630	3.9	6.7	24.5	54.0	19.0	3.9
								9135	.15	.26	.96	2.13	.75	8.49
2020082288	HCS-06-DKO-10S-S-OR-B-M-W3	06	1/4	-04	M18x1.5	-04	▲	630	3.9	6.7	26.0	55.5	22.0	5.3
								9135	.15	.26	1.02	2.19	.87	11.69
6100061562	HCS-10-DKO-12S-S-OR-B-M-W3	10	3/8	-06	M20x1.5	-05	▲	630	6.5	9.9	26.0	59.0	24	6.9
								9135	.26	.39	1.02	2.32	.94	15.21
2012032163	HCS-10-DKO-14S-S-OR-B-M-W3	10	3/8	-06	M22x1.5	-06	▲	630	6.5	9.9	30.5	64.0	27	9.7
								9135	.26	.39	1.20	2.52	1.06	21.39
6100095876	HCS-10-DKO-16S-S-OR-B-M-W3	10	3/8	-06	M24x1.5	-08	▲	630	6.5	9.9	32.0	65.5	30	11.7
								9135	.26	.39	1.26	2.58	1.18	25.80
6100096018	HCS-12-DKO-12S-W-OR-B-M-W3	12	1/2	-08	M20x1.5	-05	▲	450	9.5	13.0	24.5	60.0	24	7.2
								6527	.37	.51	.96	2.36	.94	15.88
6100096020	HCS-12-DKO-14S-W-OR-B-M-W3	12	1/2	-08	M22x1.5	-06	▲	450	9.5	13.0	26.5	62.0	27	9.8
								6527	.37	.51	1.04	2.44	1.06	21.61
2012032171	HCS-12-DKO-16S-S-OR-B-M-W3	12	1/2	-08	M24x1.5	-08	▲	450	9.5	13.0	32.0	67.5	30	12.5
								6527	.37	.51	1.26	2.66	1.18	27.56
2012032169	HCS-16-DKO-20S-S-OR-B-M-W3	16	5/8	-10	M30x2	-10	▲	420	12.6	16.0	33.5	72.0	36	18.7
								6092	.50	.63	1.32	2.83	1.42	41.12
6100096390	HCS-19-DKO-25S-S-OR-B-M-W3	19	3/4	-12	M36x2	-12	▲	420	14.8	19.1	37.0	83.0	41	27.2
								6092	.58	.75	1.46	3.27	1.61	59.98
6100099052	HCS-19-DKO-25S-S-OR-B-M-W3-SW46	19	3/4	-12	M36x2	-12	▲	420	14.8	19.1	37.0	83.0	46	35.0
								6092	.58	.75	1.46	3.27	1.81	77.18
6100096553	HCS-25-DKO-30S-S-OR-B-M-W3	25	1	-16	M42x2	-16	▲	420	20.0	25.9	40.0	95.0	50	45.4
								6092	.79	1.02	1.57	3.74	1.97	100.11
6100096693	HCS-31-DKO-38S-S-OR-B-M-W3	31	1-1/4	-20	M52x2	-20	▲	420	26.0	32.5	47.0	107.0	60	69.0
								6092	1.02	1.28	1.85	4.21	2.36	152.15





**45° Elbow Insert with Female Metric Nut Thread and 24° Taper / O-Ring  
Type DKO-..L 45° (Light Series)**

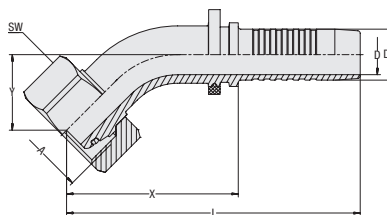

**Technical Features**

Suitable Hose Type	▲ 2SNK / ● 2SN
Connection Type	Female Metric Nut Thread
Sealing Type	24° Taper with O-Ring
Standard	ISO 8434-1
Material	Carbon Steel
Surface Finishing	Zinc/Nickel-Plating
Sealing Material	NBR (Buna-N®)

Item No.	Designation	Hose Size			Connection Size		Hose Type	Working Pressure (bar/PSI)	Dimensions (mm/in)						Weight (kg/lbs) ca. per 100
		DN	Inch	Dash	Thread	Dash			D	D1	X	L	Y	SW (Hex)	
6100096916	HCS-06-DKO-06L-045-W-OR-B-M-W3	06	1/4	-04	M12x1.5	-03	▲	450	3.9	6.7	36.5	66.5	18.0	14.0	3.1
								6527	.15	.26	1.44	2.62	.71	.55	6.73
2012032167	HCS-06-DKO-08L-045-S-OR-B-M-W3	06	1/4	-04	M14x1.5	-04	▲	450	3.9	6.7	36.0	66.0	16.0	17.0	3.6
								6527	.15	.26	1.42	2.60	.63	.67	7.94
2012032320	HCS-06-DKO-10L-045-S-OR-B-M-W3	06	1/4	-04	M16x1.5	-05	▲	450	3.9	6.7	38.5	68.5	18.5	19.0	4.9
								6527	.15	.26	1.52	2.70	.73	.75	10.69
6100095534	HCS-06-DKO-12L-045-S-OR-B-M-W3	06	1/4	-04	M18x1.5	-06	▲	450	3.9	6.7	39.5	69.5	18.5	22.0	6.0
								6527	.15	.26	1.56	2.74	.73	.87	13.23
6100095834	HCS-10-DKO-10L-045-W-OR-B-M-W3	10	3/8	-06	M16x1.5	-05	▲	385	6.5	9.9	44.0	77.0	19.5	19.0	6.5
								5584	.26	.39	1.73	3.03	.77	.75	14.33
6100058585	HCS-10-DKO-12L-045-S-OR-B-M-W3	10	3/8	-06	M18x1.5	-06	▲	385	6.5	9.9	41.5	74.5	17.5	22.0	7.2
								5584	.26	.39	1.63	2.93	.69	.87	15.88
6100095868	HCS-10-DKO-15L-045-S-OR-B-B-W3	10	3/8	-06	M22x1.5	-08	▲	385	6.5	9.9	48.0	82.0	19.5	27.0	11.4
								5584	.26	.39	1.89	3.23	.77	1.06	25.14
6100096014	HCS-12-DKO-12L-045-W-OR-B-B-W3	12	1/2	-08	M18x1.5	-06	▲	350	9.5	13.0	49.5	85.0	19.5	22.0	11.0
								5076	.37	.51	1.95	3.35	.77	.87	24.26
6100058582	HCS-12-DKO-15L-045-S-OR-B-M-W3	12	1/2	-08	M22x1.5	-08	▲	350	9.5	13.0	46.0	81.5	21.0	27.0	11.1
								5076	.37	.51	1.81	3.21	.83	1.06	24.48
6100096040	HCS-12-DKO-18L-045-S-OR-B-B-W3	12	1/2	-08	M26x1.5	-10	▲	350	9.5	13.0	67.0	102.5	27.5	32.0	20.5
								5076	.37	.51	2.64	4.04	1.08	1.26	45.20
								290	12.6	16.0	56.5	95.0	22.0	27.0	16.2
6100096189	HCS-16-DKO-15L-045-S-OR-B-B-W3	16	5/8	-10	M22x1.5	-08	▲	4206	.50	.63	2.22	3.74	.87	1.06	35.72
								290	12.6	16.0	54.0	92.0	24.0	32.0	15.9
								4206	.50	.63	2.13	3.62	.94	1.26	35.06
6100096219	HCS-16-DKO-22L-045-S-OR-B-B-W3	16	5/8	-10	M30x2	-12	▲	290	12.6	16.0	72.0	110.5	29.5	36.0	29.20
								4206	.50	.63	2.83	4.35	1.16	1.42	64.39
								280	14.8	19.1	67.5	113.5	27.5	32.0	24.20
6100096361	HCS-19-DKO-18L-045-S-OR-B-B-W3	19	3/4	-12	M26x1.5	-10	▲	4061	.58	.75	2.66	4.47	1.08	1.26	53.36
								280	14.8	19.1	67.0	113.0	25.5	36.0	25.70
								4061	.58	.75	2.64	4.45	1.00	1.42	56.67
6100096526	HCS-25-DKO-22L-045-S-OR-B-B-W3	25	1	-16	M30x2	-12	▲	200	20.0	25.9	74.5	129.5	29.5	36.0	39.03
								2901	.79	1.02	2.93	5.10	1.16	1.42	86.06
								200	20.0	25.9	80.0	135.0	33.0	41.0	41.80
2014901595	HCS-25-DKO-28L-045-S-OR-B-M-W3	25	1	-16	M36x2	-16	▲	2901	.79	1.02	3.15	5.31	1.30	1.61	92.17
								200	20.0	25.9	82.5	138.0	34.5	50.0	58.00
								200	20.0	25.9	74.5	129.5	29.5	36.0	39.03
6100096556	HCS-25-DKO-35L-045-S-OR-B-B-W3	25	1	-16	M45x2	-20	▲	2901	.79	1.02	3.25	5.43	1.36	1.97	127.89
								175	26.0	32.5	85.0	145.0	33.0	41.0	59.05
								2538	1.02	1.28	3.35	5.71	1.30	1.61	130.21
6100096669	HCS-31-DKO-28L-045-S-OR-B-B-W3	31	1-1/4	-20	M36x2	-16	▲	175	26.0	32.5	99.5	159.5	39.5	50.0	70.70
								2538	1.02	1.28	3.92	6.28	1.56	1.97	155.89
								100	31.0	38.9	107.5	175.0	38.5	60.0	102.30
6100096675	HCS-31-DKO-35L-045-S-OR-B-M-W3	31	1-1/4	-20	M45x2	-20	▲	1450	1.22	1.53	4.23	6.89	1.52	2.36	225.57
								100	31.0	38.9	107.5	175.0	38.5	60.0	102.30
6100059450	HCS-38-DKO-42L-045-S-OR-B-M-W3	38	1-1/2	-24	M52x2	-24	●	100	31.0	38.9	107.5	175.0	38.5	60.0	102.30

Dimension Y ± 2.5 mm / .10 in

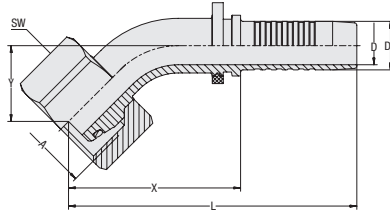
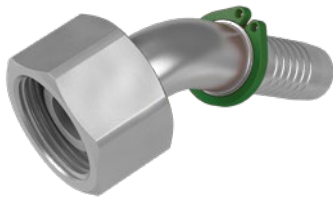

**45° Elbow Insert with Female Metric Nut Thread and 24° Taper / O-Ring  
Type DKO-..S 45° (Heavy Series)**

**Technical Features**

Suitable Hose Type	▲ 2SNK
Connection Type	Female Metric Nut Thread
Sealing Type	24° Taper with O-Ring
Standard	ISO 8434-1
Material	Carbon Steel
Surface Finishing	Zinc/Nickel-Plating
Sealing Material	NBR (Buna-N®)

Item No.	Designation	Hose Size			Connection Size		Hose Type	Working Pressure ( <sup>bar</sup> / <sub>psi</sub> )	Dimensions ( <sup>mm</sup> / <sub>in</sub> )					Weight ( <sup>kg</sup> / <sub>lbs</sub> ) ca. per 100	
		DN	Inch	Dash	Thread	Dash			D	D1	X	L	Y		SW <sub>(Hex)</sub>
6100096940	HCS-06-DKO-08S-045-S-OR-B-M-W3	06	1/4	-04	M16x1.5	-03	▲	630	3.9	6.7	36.0	66.0	16.0	19	4.3
								9135	.15	.26	1.42	2.60	.63	.75	9.37
6100095522	HCS-06-DKO-10S-045-S-OR-B-M-W3	06	1/4	-04	M18x1.5	-04	▲	630	3.9	6.7	38.5	68.5	18.5	22	6.2
								9135	.15	.26	1.52	2.70	.73	.87	13.67
6100095853	HCS-10-DKO-12S-045-S-OR-B-M-W3	10	3/8	-06	M20x1.5	-05	▲	630	6.5	9.9	41.5	74.5	17.5	24	8.2
								9135	.26	.39	1.63	2.93	.69	.94	18.08
2012032164	HCS-10-DKO-14S-045-S-OR-B-M-W3	10	3/8	-06	M22x1.5	-06	▲	630	6.5	9.9	46.0	79.0	20.0	27	11.1
								9135	.26	.39	1.81	3.11	.79	1.06	24.37
6100096032	HCS-12-DKO-16S-045-S-OR-B-M-W3	12	1/2	-08	M24x1.5	-08	▲	450	9.5	13.0	50.5	86.0	24.0	30	14.7
								6527	.37	.51	1.99	3.39	.94	1.18	32.41
6100096208	HCS-16-DKO-20S-045-S-OR-B-M-W3	16	5/8	-10	M30x2	-10	▲	420	12.6	16.0	56.5	95.0	25.0	36	21.8
								6092	.50	.63	2.22	3.74	.98	1.42	47.96
6100096381	HCS-19-DKO-25S-045-S-OR-B-M-W3	19	3/4	-12	M36x2	-12	▲	420	14.8	19.1	66.0	111.5	29.0	41	33.0
								6092	.58	.75	2.60	4.39	1.14	1.61	72.65
6100096384	HCS-19-DKO-25S-045-S-OR-B-M-W3-SW46	19	3/4	-12	M36x2	-12	▲	420	14.8	19.1	66.0	111.5	29.0	46	33.0
								6092	.58	.75	2.60	4.39	1.14	1.81	72.77
6100096545	HCS-25-DKO-30S-045-S-OR-B-M-W3	25	1	-16	M42x2	-16	▲	420	20.0	25.9	83.0	138.0	36.5	50	58.6
								6092	.79	1.02	3.27	5.43	1.44	1.97	129.10
6100096685	HCS-31-DKO-38S-045-S-OR-B-M-W3	31	1-1/4	-20	M52x2	-20	▲	420	26.0	32.5	101.5	161.5	41.5	60	92.6
								6092	1.02	1.28	4.00	6.36	1.63	2.36	204.18

Dimension Y ± 2.5 mm / .10 in



90° Elbow Insert with Female Metric Nut Thread and 24° Taper / O-Ring  
Type DKO-..L 90° (Light Series)

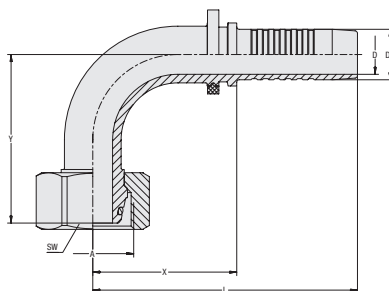

Technical Features

Suitable Hose Type	▲ 2SNK / ● 2SN
Connection Type	Female Metric Nut Thread
Sealing Type	24° Taper with O-Ring
Standard	ISO 8434-1
Material	Carbon Steel
Surface Finishing	Zinc/Nickel-Plating
Sealing Material	NBR (Buna-N®)

Item No.	Designation	Hose Size			Connection Size		Hose Type	Working Pressure (bar/PSI)	Dimensions (mm/in)					Weight (kg/lbs) ca. per 100	
		DN	Inch	Dash	Thread	Dash			D	D1	X	L	Y		SW (Hex)
6100096919	HCS-06-DKO-06L-090-W-OR-B-M-W3	06	1/4	-04	M12x1.5	-03	▲	450	3.9	6.7	25.0	55.0	32.5	14	3.3
								6527	.15	.26	.98	2.17	1.28	.55	7.28
6100011382	HCS-06-DKO-08L-090-S-OR-B-M-W3	06	1/4	-04	M14x1.5	-04	▲	450	3.9	6.7	29.5	59.5	29.0	17	3.9
								6527	.15	.26	1.16	2.34	1.14	.67	8.60
6100060799	HCS-06-DKO-10L-090-S-OR-B-M-W3	06	1/4	-04	M16x1.5	-05	▲	450	3.9	6.7	31.0	61.0	31.5	19	5.4
								6527	.15	.26	1.22	2.40	1.24	.75	11.91
6100095536	HCS-06-DKO-12L-090-S-OR-B-M-W3	06	1/4	-04	M18x1.5	-06	▲	450	3.9	6.7	30.5	60.5	33.0	22	6.5
								6527	.15	.26	1.20	2.38	1.30	.87	14.33
6100095837	HCS-10-DKO-10L-090-W-OR-B-M-W3	10	3/8	-06	M16x1.5	-05	▲	385	6.5	9.9	38.5	71.5	39.0	19	7.7
								5584	.26	.39	1.52	2.81	1.54	.75	16.98
6100058584	HCS-10-DKO-12L-090-S-OR-B-M-W3	10	3/8	-06	M18x1.5	-06	▲	385	6.5	9.9	37.5	71.0	36.0	22	8.4
								5584	.26	.39	1.48	2.80	1.42	.87	18.41
6100095869	HCS-10-DKO-15L-090-S-OR-B-B-W3	10	3/8	-06	M22x1.5	-08	▲	385	6.5	9.9	39.0	72.5	38.5	27	12.3
								5584	.26	.39	1.54	2.85	1.52	1.06	27.01
6100096041	HCS-12-DKO-18L-090-S-OR-B-B-W3	12	1/2	-08	M26x1.5	-10	▲	350	9.5	13.0	55.5	91.0	54.0	32	22.8
								5076	.37	.51	2.19	3.58	2.13	1.26	50.27
6100096190	HCS-16-DKO-15L-090-S-OR-B-B-W3	16	5/8	-10	M22x1.5	-08	▲	290	12.6	16.0	46.5	85.0	44.5	27	17.7
								4206	.50	.63	1.83	3.35	1.75	1.06	38.92
2012032323	HCS-16-DKO-18L-090-S-OR-B-M-W3	16	5/8	-10	M26x1.5	-10	▲	290	12.6	16.0	46.0	84.0	53.5	32	18.4
								4206	.50	.63	1.81	3.31	2.11	1.26	40.57
6100096220	HCS-16-DKO-22L-090-S-OR-B-B-W3	16	5/8	-10	M30x2	-12	▲	290	12.6	16.0	62.5	101.0	61.0	36	33.3
								4206	.50	.63	2.46	3.98	2.40	1.42	73.43
6100096362	HCS-19-DKO-18L-090-S-OR-B-B-W3	19	3/4	-12	M26x1.5	-10	▲	280	14.8	19.1	56.0	102.0	54.0	32	26.5
								4061	.58	.75	2.20	4.02	2.13	1.26	58.43
6100060510	HCS-19-DKO-22L-090-S-OR-B-M-W3	19	3/4	-12	M30x2	-12	▲	280	14.8	19.1	57.5	103.0	57.0	36	29.6
								4061	.58	.75	2.26	4.06	2.24	1.42	65.16
6100096395	HCS-19-DKO-28L-090-S-OR-B-B-W3	19	3/4	-12	M36x2	-16	▲	280	14.8	19.1	63.0	109.0	61.0	41	38.9
								4061	.58	.75	2.48	4.29	2.40	1.61	85.77
6100096527	HCS-25-DKO-22L-090-S-OR-B-B-W3	25	1	-16	M30x2	-12	▲	200	20.0	25.9	64.0	119.0	61.0	36	43.2
								2901	.79	1.02	2.52	4.69	2.40	1.42	95.15
2014901596	HCS-25-DKO-28L-090-S-OR-B-M-W3	25	1	-16	M36x2	-16	▲	200	20.0	25.9	72.0	127.0	63.0	41	48.2
								2901	.79	1.02	2.83	5.00	2.48	1.61	106.17
6100096557	HCS-25-DKO-35L-090-S-OR-B-B-W3	25	1	-16	M45x2	-20	▲	200	20.0	25.9	74.0	129.0	73.0	50	65.9
								2901	.79	1.02	2.91	5.08	2.87	1.97	145.20
6100096670	HCS-31-DKO-28L-090-S-OR-B-B-W3	31	1-1/4	-20	M36x2	-16	▲	175	26.0	32.5	76.5	136.5	71.0	41	66.8
								2538	1.02	1.28	3.01	5.37	2.80	1.61	147.29
2012032236	HCS-31-DKO-35L-090-S-OR-B-M-W3	31	1-1/4	-20	M45x2	-20	▲	175	26.0	32.5	90.5	150.5	81.0	50	82.6
								2538	1.02	1.28	3.56	5.93	3.19	1.97	182.13
6100096776	HCS-38-DKO-35L-090-S-OR-B-B-W3	38	1-1/2	-24	M45x2	-20	●	100	31.0	38.9	94.5	162.5	91.0	50	104.3
								1450	1.22	1.53	3.72	6.40	3.58	1.97	229.98
6100059449	HCS-38-DKO-42L-090-S-OR-B-M-W3	38	1-1/2	-24	M52x2	-24	●	100	31.0	38.9	101.0	168.5	88.0	60	117.9
								1450	1.22	1.53	3.98	6.63	3.46	2.36	259.97

Dimension Y ± 2.5 mm / .10 in

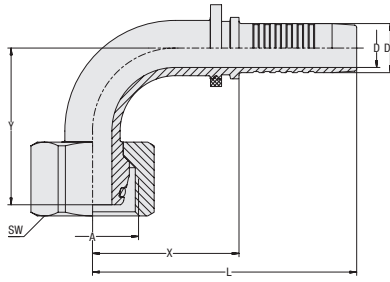

**90° Elbow Insert with Female Metric Nut Thread and 24° Taper / O-Ring  
Type DKO-..S 90° (Heavy Series)**

**Technical Features**

Suitable Hose Type	▲ 2SNK
Connection Type	Female Metric Nut Thread
Sealing Type	24° Taper with O-Ring
Standard	ISO 8434-1
Material	Carbon Steel
Surface Finishing	Zinc/Nickel-Plating
Sealing Material	NBR (Buna-N®)

Item No.	Designation	Hose Size			Connection Size		Hose Type	Working Pressure ( <sup>bar</sup> / <sub>PSI</sub> )	Dimensions ( <sup>mm</sup> / <sub>in</sub> )					Weight ( <sup>kg</sup> / <sub>lbs</sub> ) ca. per 100	
		DN	Inch	Dash	Thread	Dash			D	D1	X	L	Y		SW (Hex)
6100060989	HCS-06-DKO-08S-090-S-OR-B-M-W3	06	1/4	-04	M16x1.5	-03	▲	630	3.9	6.7	29.5	59.5	29.0	19	4.5
								9135	.15	.26	1.16	2.34	1.14	.75	9.92
6100095525	HCS-06-DKO-10S-090-S-OR-B-M-W3	06	1/4	-04	M18x1.5	-04	▲	630	3.9	6.7	31.0	61.0	31.5	22	6.6
								9135	.15	.26	1.22	2.40	1.24	.87	14.44
6100095674	HCS-08-DKO-10S-090-S-OR-B-M-W3	08	5/16	-05	M18x1.5	-04	▲	630	5.4	8.2	31.0	61.0	31.5	22	6.7
								9135	.21	.32	1.22	2.40	1.24	.87	14.77
6100095694	HCS-08-DKO-12S-090-S-OR-B-M-W3	08	5/16	-05	M20x1.5	-05	▲	630	5.4	8.2	31.0	61.0	33.0	24	7.8
								9135	.21	.32	1.22	2.40	1.30	.94	17.09
2014090112	HCS-10-DKO-12S-090-S-OR-B-M-W3	10	3/8	-06	M20x1.5	-05	▲	630	6.5	9.9	37.5	71.0	36.0	24	9.3
								9135	.26	.39	1.48	2.80	1.42	.94	20.51
6100058575	HCS-10-DKO-14S-090-S-OR-B-M-W3	10	3/8	-06	M22x1.5	-06	▲	630	6.5	9.9	38.5	72.0	40.0	27	12.2
								9135	.26	.39	1.52	2.83	1.57	1.06	26.79
2020082289	HCS-12-DKO-16S-090-S-OR-B-M-W3	12	1/2	-08	M24x1.5	-08	▲	450	9.5	13.0	40.0	75.5	47.0	30	16.1
								6527	.37	.51	1.57	2.97	1.85	1.18	35.50
6100096212	HCS-16-DKO-20S-090-S-OR-B-M-W3	16	5/8	-10	M30x2	-10	▲	420	12.6	16.0	49.0	86.5	52.0	36	23.9
								6092	.50	.63	1.93	3.41	2.05	1.42	52.70
6100096386	HCS-19-DKO-25S-090-S-OR-B-M-W3	19	3/4	-12	M36x2	-12	▲	420	14.8	19.1	57.0	102.5	58.5	41	37.5
								6092	.58	.75	2.24	4.04	2.30	1.61	82.69
6100099050	HCS-19-DKO-25S-090-S-OR-B-M-W3-SW46	19	3/4	-12	M36x2	-12	▲	420	14.8	19.1	57.0	102.5	58.5	46	37.5
								6092	.58	.75	2.24	4.04	2.30	1.81	82.69
6100096549	HCS-25-DKO-30S-090-S-OR-B-M-W3	25	1	-16	M42x2	-16	▲	420	20.0	25.9	70.5	125.5	74.0	50	66.2
								6092	.79	1.02	2.78	4.94	2.91	1.97	145.86
6100096689	HCS-31-DKO-38S-090-S-OR-B-M-W3	31	1-1/4	-20	M52x2	-16	▲	420	26.0	32.5	88.0	147.5	87.0	60	105.6
								6092	1.02	1.28	3.46	5.81	3.43	2.36	232.74

Dimension Y ± 2.5 mm / .10 in



### Straight Insert with Male BSPP Thread and 60° Conical Bore Type AGR

2SNK  
2SN

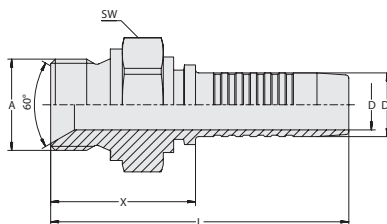

#### Technical Features

Suitable Hose Type	▲ 2SNK / ● 2SN
Connection Type	Male BSPP Thread
Sealing Type	60° Conical Bore
Standard	ISO 8434-6, BS 5200
Material	Carbon Steel
Surface Finishing	Zinc/Nickel-Plating

Item No.	Designation	Hose Size			Connection Size		Hose Type	Working Pressure (bar/PSI)	Dimensions (mm/in)					Weight (kg/lbs) ca. per 100
		DN	Inch	Dash	Thread	Dash			D	D1	X	L	SW (Hex)	
6100095466	HCS-06-AGR-04-M-W3	06	1/4	-04	G 1/4	-04	▲	350	3.9	6.7	29.0	59.0	19	3.9
								5075	.15	.26	1.14	2.32	.75	8.49
6100095775	HCS-10-AGR-06-M-W3	10	3/8	-06	G 3/8	-06	▲	350	6.5	9.9	30.0	63.5	22	6.3
								5075	.26	.39	1.18	2.50	.87	13.78
6100095777	HCS-10-AGR-08-M-W3	10	3/8	-06	G 1/2	-08	▲	350	6.5	9.9	33.5	67.0	27	9.0
								5075	.26	.39	1.32	2.64	1.06	19.85
6100095956	HCS-12-AGR-06-M-W3	12	1/2	-08	G 3/8	-06	▲	315	9.5	13.0	31.0	66.5	22	6.7
								4568	.26	.38	1.10	2.74	.87	14.99
6100095958	HCS-12-AGR-08-M-W3	12	1/2	-08	G 1/2	-08	▲	315	9.5	13.0	34.5	70.0	27	10.1
								4568	.37	.51	1.36	2.76	1.06	22.27
6100096150	HCS-16-AGR-10-M-W3	16	5/8	-10	G 5/8	-10	▲	315	12.6	16.0	36.5	75.0	30	12.4
								4568	.50	.63	1.44	2.95	1.18	27.34
6100096152	HCS-16-AGR-12-M-W3	16	5/8	-10	G 3/4	-12	▲	315	12.6	16.0	37.5	76.0	32	13.9
								4568	.50	.63	1.48	2.99	1.26	30.65
6100096315	HCS-19-AGR-12-M-W3	19	3/4	-12	G 3/4	-12	▲	250	14.8	19.1	38.0	84.0	32	16.6
								3625	.58	.75	1.50	3.31	1.26	36.60
6100096489	HCS-25-AGR-16-M-W3	25	1	-16	G 1	-16	▲	200	20.0	25.9	43.0	98.5	41	30.8
								2900	.79	1.02	1.69	3.88	1.61	67.91
6100096632	HCS-31-AGR-20-M-W3	31	1-1/4	-20	G 1-1/4	-20	▲	180	26.0	32.5	46.5	106.5	50	47.1
								2610	1.02	1.28	1.83	4.19	1.97	103.90
6100096753	HCS-38-AGR-24-M-W3	38	1-1/2	-24	G 1-1/2	-24	●	125	31.0	38.9	52.5	120.5	55	69.3
								1813	1.22	1.53	2.07	4.74	2.17	152.81
6100096834	HCS-51-AGR-32-M-W3	51	2	-32	G 2	-32	●	80	40.0	51.6	60.0	135.5	70	134.6
								1160	1.57	2.03	2.36	5.33	2.76	296.79

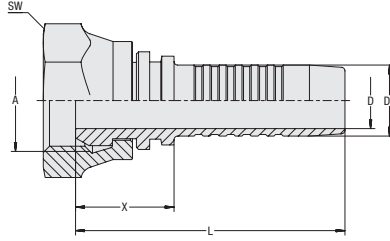

**Straight Insert with Female BSPP Thread and 60° Taper  
Type DKR**

**Technical Features**

Suitable Hose Type	▲ 2SNK
Connection Type	Female BSPP Nut Thread
Sealing Type	60° Taper
Standard	ISO 8434-6, BS 5200
Material	Carbon Steel
Surface Finishing	Zinc/Nickel-Plating

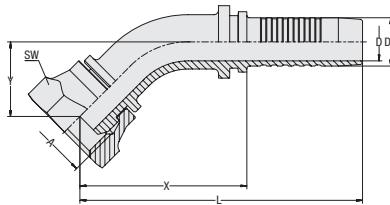

Item No.	Designation	Hose Size			Connection Size		Hose Type	Working Pressure ( <sup>barr</sup> /PSI)	Dimensions ( <sup>mm</sup> / <sub>in</sub> )					Weight ( <sup>kg</sup> / <sub>lbs</sub> ) ca. per 100
		DN	Inch	Dash	Thread	Dash			D	D1	X	L	SW (Hex)	
2012031322	HCS-06-DKR-04-S-M-W3	06	1/4	-04	G 1/4	-04	▲	350	3.9	6.7	22.5	52.5	19	4.0
								5075	.15	.26	.89	2.07	.75	8.82
6100129071	HCS-06-DKR-06-S-M-W3	06	1/4	-04	G 3/8	-06	▲	350	3.9	6.7	25.5	56.0	22	5.4
								5075	.15	.26	1.00	2.20	.87	11.91
2012031323	HCS-10-DKR-06-S-M-W3	10	3/8	-06	G 3/8	-06	▲	350	6.5	9.9	23.5	57.0	22	6.2
								5075	.26	.39	.93	2.24	.87	13.56
6100095904	HCS-10-DKR-08-C-M-W3	10	3/8	-06	G 1/2	-08	▲	350	6.5	9.9	22.0	55.5	27	8.2
								5075	.26	.39	.87	2.19	1.06	18.08
6100129077	HCS-12-DKR-08-S-M-W3	12	1/2	-08	G 1/2	-08	▲	315	9.5	13.0	27.0	62.5	27	10.2
								4568	.37	.51	1.06	2.46	1.06	22.38
6100096244	HCS-16-DKR-10-C-M-W3	16	5/8	-10	G 5/8	-10	▲	315	12.6	16.0	22.0	60.5	30	10.5
								4568	.50	.63	.87	2.38	1.18	23.15
6100060726	HCS-19-DKR-12-C-M-W3	19	3/4	-12	G 3/4	-12	▲	250	14.8	19.1	24.5	70.5	32	14.5
								3625	.58	.75	.96	2.78	1.26	31.86
6100060725	HCS-25-DKR-16-C-M-W3	25	1	-16	G 1	-16	▲	200	20.0	25.9	25.0	80.5	41	22.5
								2900	.79	1.02	.98	3.17	1.61	49.61
6100096708	HCS-31-DKR-20-W-M-W3	31	1-1/4	-20	G 1-1/4	-20	▲	180	26.0	32.5	32.0	92.0	50	48.7
								2610	1.02	1.28	1.26	3.62	1.97	107.38

**45° Elbow Insert with Female BSPP Thread and 60° Taper  
Type DKR 45°**

**Technical Features**

Suitable Hose Type	▲ 2SNK
Connection Type	Female BSPP Nut Thread
Sealing Type	60° Taper
Standard	ISO 8434-6, BS 5200
Material	Carbon Steel
Surface Finishing	Zinc/Nickel-Plating

Item No.	Designation	Hose Size			Connection Size		Hose Type	Working Pressure ( <sup>barr</sup> /PSI)	Dimensions ( <sup>mm</sup> / <sub>in</sub> )						Weight ( <sup>kg</sup> / <sub>lbs</sub> ) ca. per 100
		DN	Inch	Dash	Thread	Dash			D	D1	X	L	Y	SW (Hex)	
2012031327	HCS-06-DKR-04-045-C-M-W3	06	1/4	-04	G 1/4	-04	▲	350	3.9	6.7	36.0	66.0	15.5	19	4.3
								5075	.15	.26	1.42	2.60	.61	.75	9.48
6100129072	HCS-06-DKR-06-045-S-M-W3	06	1/4	-04	G 3/8	-06	▲	350	3.9	6.7	37.5	67.5	16.0	22	6.4
								5075	.15	.26	1.48	2.66	.63	.87	14.11
2012031328	HCS-10-DKR-06-045-C-M-W3	10	3/8	-06	G 3/8	-06	▲	350	6.5	9.9	41.0	74.5	18.0	22	7.2
								5075	.26	.39	1.61	2.93	.71	.87	15.88
2012031329	HCS-12-DKR-08-045-S-M-W3	12	1/2	-08	G 1/2	-08	▲	315	9.5	13.0	50.5	85.5	20.0	27	12.2
								4568	.37	.51	1.99	3.37	.79	106	26.79
6100096242	HCS-16-DKR-10-045-C-M-W3	16	5/8	-10	G 5/8	-10	▲	315	12.6	16.0	55.5	93.5	24.5	30	15.6
								4568	.50	.63	2.19	3.68	.96	1.18	34.40
6100096408	HCS-19-DKR-12-045-C-M-W3	19	3/4	-12	G 3/4	-12	▲	250	14.8	19.1	63.5	109.5	31.0	32	24.8
								3625	.58	.75	2.50	4.31	1.22	1.26	54.57
6100096567	HCS-25-DKR-16-045-C-M-W3	25	1	-16	G 1	-16	▲	200	20.0	25.9	89.0	144.0	38.0	41	48.0
								2900	.79	1.02	3.50	5.67	1.50	1.61	105.73

Dimension Y ± 2.5 mm / .10 in





90° Elbow Insert with Female BSPP Thread and 60° Taper  
Type DKR 90°

2SNK  
2SN

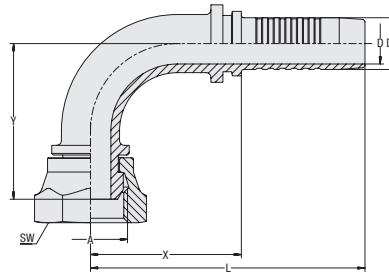

Technical Features

Suitable Hose Type	▲ 2SNK
Connection Type	Female BSPP Nut Thread
Sealing Type	60° Taper
Standard	ISO 8434-6, BS 5200
Material	Carbon Steel
Surface Finishing	Zinc/Nickel-Plating

Item No.	Designation	Hose Size			Connection Size		Hose Type	Working Pressure ( <sup>bar</sup> / <sub>PSI</sub> )	Dimensions (mm/in)						Weight ( <sup>kg</sup> / <sub>lbs</sub> ) ca. per 100
		DN	Inch	Dash	Thread	Dash			D	D1	X	L	Y	SW (Hex)	
2012031331	HCS-06-DKR-04-090-S-M-W3	06	1/4	-04	G 1/4	-04	▲	350	3.9	6.7	27.0	57.0	28.5	19	4.6
								5075	.15	.26	1.06	2.24	1.12	.75	10.14
6100129073	HCS-06-DKR-06-090-S-M-W3	10	3/8	-06	G 3/8	-06	▲	350	3.9	6.7	29.0	59.0	31.0	22	6.9
								5075	.15	.26	1.14	2.32	1.22	.87	15.10
2012031332	HCS-10-DKR-06-090-C-M-W3	10	3/8	-06	G 3/8	-06	▲	350	6.5	9.9	33.0	66.5	40.5	22	8.3
								5075	.26	.39	1.30	2.62	1.59	.87	18.30
2012031333	HCS-12-DKR-08-090-S-M-W3	12	1/2	-08	G 1/2	-08	▲	315	9.5	13.0	41.0	76.5	42.0	27	13.7
								4568	.37	.51	1.61	3.01	1.65	1.06	30.21
6100096243	HCS-16-DKR-10-090-C-M-W3	16	5/8	-10	G 5/8	-10	▲	315	12.6	16.0	46.5	85.0	48.0	30	17.5
								4568	.50	.63	1.83	3.35	1.89	1.18	38.59
6100060724	HCS-19-DKR-12-090-C-M-W3	19	3/4	-12	G 3/4	-12	▲	250	14.8	19.1	50.0	94.3	52.0	32	22.2
								3625	.58	.75	1.97	3.71	2.05	1.26	48.95
6100060722	HCS-25-DKR-16-090-C-M-W3	25	1	-16	G 1	-16	▲	200	20.0	25.9	75.5	130.5	73.5	41	58.1
								2900	.79	1.02	2.97	5.14	2.89	1.61	128.11

Dimension Y ± 2.5 mm / .10 in

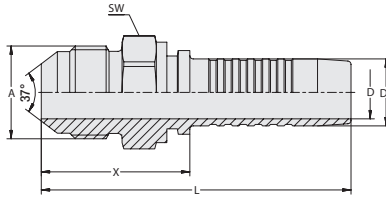

**Straight Insert with Male UN/UNF Thread and JIC 37° Taper  
Type AGJ**

**Technical Features**

Suitable Hose Type	▲ 2SNK
Connection Type	Male UN/UNF Thread
Sealing Type	JIC 37° Taper
Standard	ISO 8434-2
Material	Carbon Steel
Surface Finishing	Zinc/Nickel-Plating



Item No.	Designation	Hose Size			Connection Size		Hose Type	Working Pressure (bar/PSI)	Dimensions (mm/in)				Weight (kg/lbs) ca. per 100	
		DN	Inch	Dash	Thread	Dash			D	D1	X	L		SW (Hex)
6100095449	HCS-06-AGJ-04-M-W3	06	1/4	-04	7/16-20 UNF	-04	▲	310	3.9	6.7	28.0	58.0	14	2.4
								5000	.15	.26	1.10	2.28	.55	.09
6100095451	HCS-06-AGJ-05-M-W3	06	1/4	-04	1/2-20 UNF	-05	▲	310	3.9	6.7	28.0	58.0	14	2.5
								5000	.15	.26	1.10	2.28	.55	.10
6100095453	HCS-06-AGJ-06-M-W3	06	1/4	-04	9/16-18 UNF	-06	▲	310	3.9	6.7	28.0	58.0	17	3.1
								5000	.15	.26	1.10	2.28	.67	.12
6100095760	HCS-10-AGJ-06-M-W3	10	3/8	-06	9/16-18 UNF	-06	▲	276	6.5	9.9	28.0	61.5	17	3.9
								4000	.26	.39	1.10	2.42	.67	.15
6100095762	HCS-10-AGJ-08-M-W3	10	3/8	-06	3/4-16 UNF	-08	▲	276	6.5	9.9	31.5	65.0	22	5.9
								4000	.26	.39	1.24	2.56	.87	.23
6100095943	HCS-12-AGJ-08-M-W3	12	1/2	-08	3/4-16 UNF	-08	▲	276	9.5	13.0	32.5	68.0	22	6.7
								4000	.37	.51	1.28	2.68	.87	.26
6100095945	HCS-12-AGJ-10-M-W3	12	1/2	-08	7/8-14 UNF	-10	▲	276	9.5	13.0	35.5	71.0	24	8.3
								4000	.37	.51	1.40	2.80	.94	.32
6100096139	HCS-16-AGJ-10-M-W3	16	5/8	-10	7/8-14 UNF	-10	▲	210	12.6	16.0	35.5	74.0	24	8.8
								3000	.50	.63	1.40	2.91	.94	.34
6100096141	HCS-16-AGJ-12-M-W3	16	5/8	-10	1-1/16-12 UN	-12	▲	210	12.6	16.0	40.0	78.5	30	13.2
								3000	.50	.63	1.57	3.09	1.18	.52



### Straight Insert with Female UN/UNF Thread and JIC 37° Female Conical Bore Type DKJ

2SNK  
2SN

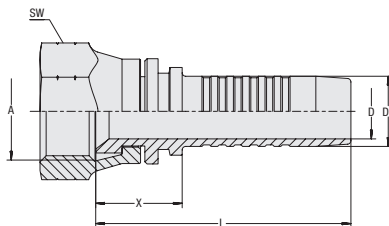

#### Technical Features

Suitable Hose Type	▲ 2SNK / ● 2SN
Connection Type	Female UN/UNF Nut Thread
Sealing Type	JIC 37° Female Conical Bore
Standard	ISO 8434-2
Material	Carbon Steel
Surface Finishing	Zinc/Nickel-Plating

Item No.	Designation	Hose Size			Connection Size		Hose Type	Working Pressure (bar/PSI)	Dimensions (mm/in)					Weight (kg/lbs) ca. per 100
		DN	Inch	Dash	Thread	Dash			D	D1	X	L	SW (Hex)	
6100095502	HCS-06-DKJ-05-C-M-W3	06	1/4	-04	1/2-20 UNF	-05	▲	310	3.9	6.7	14.5	41.0	17	2.4
								5000	.15	.26	.57	1.61	.67	5.29
6100095511	HCS-06-DKJ-06-C-M-W3	06	1/4	-04	9/16-18 UNF	-06	▲	310	3.9	6.7	17.0	47.0	19	3.5
								5000	.15	.26	.67	1.85	.75	7.61
6100095816	HCS-10-DKJ-06-C-M-W3	10	3/8	-06	9/16-18 UNF	-06	▲	276	6.5	9.9	17.0	50.5	19	4.1
								4000	.26	.39	.67	1.99	.75	9.04
6100095824	HCS-10-DKJ-08-C-M-W3	10	3/8	-06	3/4-16 UNF	-08	▲	276	6.5	9.9	17.0	50.5	24	5.9
								4000	.26	.39	.67	1.99	.94	12.90
6100095831	HCS-10-DKJ-10-C-M-W3	10	3/8	-06	7/8-14 UNF	-10	▲	276	6.5	9.9	19.0	52.5	27	7.7
								4000	.26	.39	.75	2.07	1.06	16.98
6100034505	HCS-12-DKJ-08-C-M-W3	12	1/2	-08	3/4-16 UNF	-08	▲	276	9.5	13.0	19.5	55.0	22	6.0
								4000	.37	.51	.77	2.17	.87	13.23
6100096003	HCS-12-DKJ-10-C-M-W3	12	1/2	-08	7/8-14 UNF	-10	▲	276	9.5	13.0	20.0	55.5	27	7.4
								4000	.37	.51	.79	2.19	1.06	16.32
6100096179	HCS-16-DKJ-10-C-M-W3	16	5/8	-10	7/8-14 UNF	-10	▲	210	12.6	16.0	19.5	58.0	27	8.9
								3000	.50	.63	.77	2.28	1.06	19.62
6100096186	HCS-16-DKJ-12-C-M-W3	16	5/8	-10	1-1/16-12 UN	-12	▲	210	12.6	16.0	23.0	61.5	32	13.2
								3000	.50	.63	.91	2.42	1.26	29.11
6100096341	HCS-19-DKJ-10-C-M-W3	19	3/4	-12	7/8-14 UNF	-10	▲	210	14.8	19.1	22.3	66.6	27	13.5
								3000	.58	.75	.88	2.62	1.06	29.77
6100034506	HCS-19-DKJ-12-C-M-W3	19	3/4	-12	1-1/16-12 UN	-12	▲	210	14.8	19.1	22.6	66.9	32	12.9
								3000	.58	.75	.89	2.63	1.26	28.44
6100096351	HCS-19-DKJ-16-C-M-W3	19	3/4	-12	1-5/16-12 UN	-16	▲	210	14.8	19.1	24.3	68.6	41	20.0
								3000	.58	.75	.96	2.70	1.61	44.10
6100034507	HCS-25-DKJ-16-C-M-W3	25	1	-16	1-5/16-12 UN	-16	▲	170	20.0	25.9	24.8	79.1	41	24.0
								2500	.79	1.02	.98	3.11	1.61	52.92
6100096650	HCS-31-DKJ-20-W-M-W3	31	1-1/4	-20	1-5/8-12 UN	-20	▲	140	26.0	32.5	28.1	86.0	50	43.2
								2000	1.02	1.28	1.11	3.39	1.97	95.26
6100096764	HCS-38-DKJ-24-W-M-W3	38	1-1/2	-24	1-7/8-12 UN	-24	●	105	31.0	38.9	36.0	103.5	60	81.4
								1500	1.22	1.53	1.42	4.07	2.36	179.38
6100096841	HCS-51-DKJ-32-W-M-W3	51	2	-32	2-1/2-12 UN	-32	●	80	40.0	51.6	43.5	118.5	75	153.7
								1160	1.57	2.03	1.71	4.67	2.95	338.80

### 45° Elbow Insert with Female UN/UNF Thread and JIC 37° Female Conical Bore Type DKJ 45°

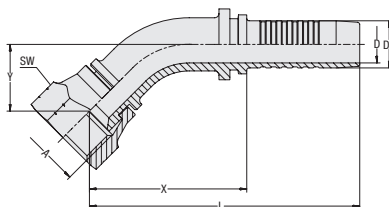

#### Technical Features

Suitable Hose Type	▲ 2SNK
Connection Type	Female UN/UNF Nut Thread
Sealing Type	JIC 37° Female Conical Bore
Standard	ISO 8434-2
Material	Carbon Steel
Surface Finishing	Zinc/Nickel-Plating

Item No.	Designation	Hose Size			Connection Size		Hose Type	Working Pressure (bar/PSI)	Dimensions (mm/in)					Weight (kg/lbs) ca. per 100	
		DN	Inch	Dash	Thread	Dash			D	D1	X	L	Y		SW (Hex)
6100095993	HCS-12-DKJ-08-045-C-M-W3	12	1/2	-08	3/4-16 UNF	-08	▲	276	9.5	13.0	45.0	80.5	21.5	22	9.2
								4000	.37	.51	1.77	3.17	.85	.87	20.18
6100096342	HCS-19-DKJ-12-045-C-M-W3	19	3/4	-12	1-1/16-12 UN	-12	▲	210	14.8	19.1	60.2	106.0	27.5	32	23.8
								3000	.58	.75	2.37	4.17	1.08	1.26	52.37

Dimension Y ± 2.5 mm / .10 in

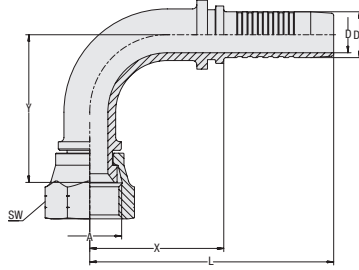

**90° Elbow Insert with Female UN/UNF Thread and JIC 37° Female Conical Bore  
Type DKJ 90°**

**Technical Features**

Suitable Hose Type	▲ 2SNK / ● 2SN
Connection Type	Female UN/UNF Nut Thread
Sealing Type	JIC 37° Female Conical Bore
Standard	ISO 8434-2
Material	Carbon Steel
Surface Finishing	Zinc/Nickel-Plating

Item No.	Designation	Hose Size			Connection Size		Hose Type	Working Pressure (bar/PSI)	Dimensions (mm/in)					Weight ( <sup>kg</sup> /lbs) ca. per 100	
		DN	Inch	Dash	Thread	Dash			D	D1	X	L	Y		SW (Hex)
6100095492	HCS-06-DKJ-04-090-C-M-W3	06	1/4	-04	7/16-20 UNF	-04	▲	310	3.9	6.7	25.5	55.5	31.5	14	3.2
								5000	.15	.26	1.00	2.19	1.24	.55	6.95
6100095499	HCS-06-DKJ-05-090-C-M-W3	06	1/4	-04	1/2-20 UNF	-05	▲	310	3.9	6.7	27.0	57.0	27.5	17	4.0
								5000	.15	.26	1.06	2.24	1.08	.67	8.71
6100095508	HCS-06-DKJ-06-090-C-M-W3	06	1/4	-04	9/16-18 UNF	-06	▲	310	3.9	6.7	32.5	62.5	30.0	19	4.7
								5000	.15	.26	1.28	2.46	1.18	.75	10.36
6100095814	HCS-10-DKJ-06-090-C-M-W3	10	3/8	-06	9/16-18 UNF	-06	▲	276	6.5	9.9	35.0	69.0	36.5	19	7.3
								4000	.26	.39	1.38	2.72	1.44	.75	16.10
6100095821	HCS-10-DKJ-08-090-C-M-W3	10	3/8	-06	3/4-16 UNF	-08	▲	276	6.5	9.9	37.0	70.0	33.0	24	9.2
								4000	.26	.39	1.46	2.76	1.30	.94	20.18
6100034502	HCS-12-DKJ-08-090-C-M-W3	12	1/2	-08	3/4-16 UNF	-08	▲	276	9.5	13.0	39.5	75.0	42.0	22	10.7
								4000	.37	.51	1.56	2.95	1.65	.87	23.59
6100096000	HCS-12-DKJ-10-090-C-M-W3	12	1/2	-08	7/8-14 UNF	-10	▲	276	9.5	13.0	39.0	77.0	43.5	27	13.6
								4000	.37	.51	1.54	3.03	1.71	1.06	29.99
6100096177	HCS-16-DKJ-10-090-C-M-W3	16	5/8	-10	7/8-14 UNF	-10	▲	210	12.6	16.0	46.5	85.0	51.5	27	16.2
								3000	.50	.63	1.83	3.35	2.03	1.06	35.61
6100096183	HCS-16-DKJ-12-090-C-M-W3	16	5/8	-10	1-1/16-12 UN	-12	▲	210	12.6	16.0	45.0	83.5	48.5	32	20.3
								3000	.50	.63	1.77	3.29	1.91	1.26	44.76
6100034503	HCS-19-DKJ-12-090-C-M-W3	19	3/4	-12	1-1/16-12 UN	-12	▲	210	14.8	19.1	54.0	100.0	54.5	32	28.1
								3000	.58	.75	2.13	3.94	2.15	1.26	61.85
6100034504	HCS-25-DKJ-16-090-C-M-W3	25	1	-16	1-5/16-12 UN	-16	▲	170	20.0	25.9	72.0	126.3	67.0	41	43.0
								2500	.79	1.02	2.83	4.97	2.64	1.61	94.82
6100096648	HCS-31-DKJ-20-090-W-M-W3	31	1-1/4	-20	1-5/8-12 UN	-20	▲	140	26.0	32.5	91.5	151.5	99.0	50	102.7
								2000	1.02	1.28	3.60	5.96	3.90	1.97	226.34
6100096840	HCS-51-DKJ-32-090-W-M-W3	51	2	-32	2-1/2-12 UN	-32	●	80	40.0	51.6	122.0	197.0	140.0	75	261.0
								1160	1.57	2.03	4.80	7.76	5.51	2.95	575.39

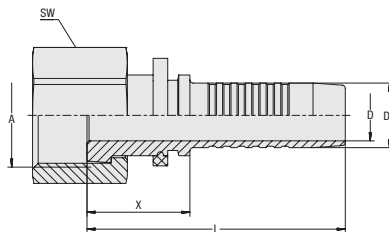
Dimension Y ± 2.5 mm / .10 in

**Straight Insert with Female UN/UNF Thread for O-Ring Face Seal Connection  
Type ORS**

**Technical Features**

Suitable Hose Type	▲ 2SNK
Connection Type	Female UN/UNF Nut Thread
Sealing Type	O-Ring Face Seal
Standard	ISO 8434-3
Material	Carbon Steel
Surface Finishing	Zinc/Nickel-Plating

Item No.	Designation	Hose Size			Connection Size		Hose Type	Working Pressure (bar/PSI)	Dimensions (mm/in)					Weight ( <sup>kg</sup> /lbs) ca. per 100
		DN	Inch	Dash	Thread	Dash			D	D1	X	L	SW (Hex)	
6100095581	HCS-06-ORS-04-S-M-W3	06	1/4"	-04	9/16"-18 UNF	-04	▲	413	3.9	6.7	24.5	54.5	17	3.2
								6000	.15	.26	.96	2.15	.67	.13
6100116609	HCS-06-ORS-06-S-M-W3	06	1/4"	-04	11/16"-16 UN	-06	▲	413	3.9	6.7	30.0	60.0	22	6.4
								6000	.15	.26	1.18	2.36	.87	.25
6100095920	HCS-10-ORS-06-S-M-W3	10	3/8"	-06	11/16"-16 UN	-06	▲	413	6.5	9.9	21.5	55.0	22	6.1
								6000	.26	.39	.85	2.17	.87	.24
6100095925	HCS-10-ORS-08-S-M-W3	10	3/8"	-06	13/16"-16 UN	-08	▲	413	6.5	9.9	28.5	62.0	24	7.7
								6000	.26	.39	1.12	2.44	.94	.30
6100096095	HCS-12-ORS-08-S-M-W3	12	1/2"	-08	13/16"-16 UN	-08	▲	413	9.5	13.0	28.0	59.0	24	8.1
								6000	.37	.51	1.10	2.32	.94	.32
6100096432	HCS-19-ORS-12-S-M-W3	19	3/4"	-12	1 3/16"-12 UN	-12	▲	413	14.8	19.1	41.6	87.6	36	22.8
								6000	.58	.75	1.64	3.45	1.42	.90
6100096586	HCS-25-ORS-16-S-M-W3	25	1"	-16	1 7/16"-12 UN	-16	▲	345	20.0	25.9	40.3	95.5	41	33.2
								5000	.79	1.02	1.59	3.76	1.61	1.31

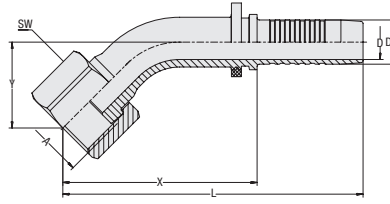

### 45° Elbow Insert with Female UN/UNF Thread for O-Ring Face Seal Connection Type ORS 45°



#### Technical Features

Suitable Hose Type	▲ 2SNK
Connection Type	Female UN/UNF Nut Thread
Sealing Type	O-Ring Face Seal
Standard	ISO 8434-3
Material	Carbon Steel
Surface Finishing	Zinc/Nickel-Plating

2SNK  
2SN

Item No.	Designation	Hose Size			Connection Size		Hose Type	Working Pressure (bar/PSI)	Dimensions (mm/in)					Weight (kg/lbs) ca. per 100	
		DN	Inch	Dash	Thread	Dash			D	D1	X	L	Y		SW (Hex)
6100116610	HCS-06-ORS-06-045-S-M-W3	06	1/4"	-04	11/16"-16 UN	-06	▲	310	3.9	6.7	43.4	73.6	19.4	22	5.9
								5000	.15	.26	1.71	2.90	.76	.87	13.01
6100095917	HCS-10-ORS-06-045-S-M-W3	10	3/8"	-06	11/16"-16 UN	-06	▲	310	6.5	9.9	43.0	76.5	18.0	22	7.6
								5000	.26	.39	1.69	3.01	.71	.87	16.76
6100116586	HCS-10-ORS-08-045-S-M-W3	10	3/8"	-06	13/16"-16 UN	-08	▲	310	6.5	9.9	44.5	78.0	19.5	22	8.9
								5000	.26	.39	1.75	3.07	.77	.87	19.62
6100096092	HCS-12-ORS-08-045-S-M-W3	12	1/2"	-08	13/16"-16 UN	-08	▲	276	9.5	13.0	47.5	82.5	21.0	27	10.2
								4000	.37	.51	1.87	3.25	.83	1.06	22.49
6100096261	HCS-16-ORS-10-045-S-M-W3	16	5/8"	-10	1"-14 UNS	-10	▲	276	12.6	16.0	52.5	91.0	23.5	30	16.0
								4000	.50	.63	2.07	3.58	.93	1.18	35.28
6100116629	HCS-19-ORS-12-045-S-M-W3	19	3/4"	-12	1 3/16"-12 UN	-12	▲	276	14.8	19.1	60.8	106.8	27.3	36	26.9
								4000	.58	.75	2.39	4.20	1.07	1.42	59.29

Dimension Y ± 2,5 mm / .10 in

### 90° Elbow Insert with Female UN/UNF Thread for O-Ring Face Seal Connection Type ORS 90°

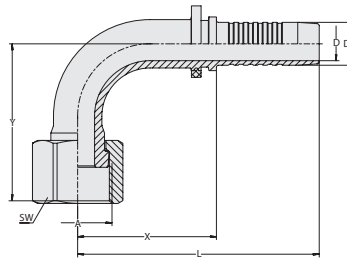

#### Technical Features

Suitable Hose Type	▲ 2SNK
Connection Type	Female UN/UNF Nut Thread
Sealing Type	O-Ring Face Seal
Standard	ISO 8434-3
Material	Carbon Steel
Surface Finishing	Zinc/Nickel-Plating

Item No.	Designation	Hose Size			Connection Size		Hose Type	Working Pressure (bar/PSI)	Dimensions (mm/in)					Weight (kg/lbs) ca. per 100	
		DN	Inch	Dash	Thread	Dash			D	D1	X	L	Y		SW (Hex)
6100095580	HCS-06-ORS-04-090-S-M-W3	06	1/4"	-04	9/16"-18 UNF	-04	▲	310	3.9	6.7	32.8	63.0	33.1	17	3.7
								5000	.15	.26	1.29	2.48	1.30	.67	8.16
6100116611	HCS-06-ORS-06-090-S-M-W3	06	1/4"	-04	11/16"-16 UN	-06	▲	310	3.9	6.7	32.8	63.0	36.3	22	0.0
								5000	.15	.26	1.29	2.48	1.43	.87	.00
6100095918	HCS-10-ORS-06-090-S-M-W3	10	3/8"	-06	11/16"-16 UN	-06	▲	310	6.5	9.9	37.0	70.5	37.0	22	8.9
								5000	.26	.39	1.46	2.78	1.46	.87	19.51
6100095923	HCS-10-ORS-08-090-S-M-W3	10	3/8"	-06	13/16"-16 UN	-08	▲	276	6.5	9.9	37.0	70.5	39.5	24	9.3
								4000	.26	.39	1.46	2.78	1.56	.94	20.51
6100096093	HCS-12-ORS-08-090-S-M-W3	12	1/2"	-08	13/16"-16 UN	-08	▲	276	9.5	13.0	40.5	76.0	43.5	27	14.6
								4000	.37	.51	1.59	2.99	1.71	1.06	32.08
6100116630	HCS-19-ORS-12-090-S-M-W3	19	3/4"	-12	1 3/16"-12 UN	-12	▲	276	14.8	19.1	52.8	98.8	58.0	36	29.4
								4000	.58	.75	2.08	3.89	2.28	1.42	64.83
6100096717	HCS-31-ORS-20-090-S-M-W3	31	1 1/4"	-20	1 11/16"-12 UN	-20	▲	210	26.0	32.5	76.3	136.3	78.2	50	67.1
								3000	1.02	1.28	3.00	5.37	3.08	1.97	147.96

Dimension Y ± 2.5 mm / .10 in

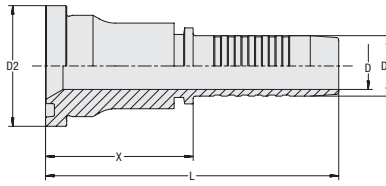

**Straight Insert with SAE Flange Adaptor  
Type SFL (3000 PSI Series)**

**Technical Features**

Suitable Hose Type	▲ 2SNK / ● 2SN
Connection Type	SAE Flange Adaptor
Sealing Type	O-Ring Face Seal (O-Ring not included in delivery.)
Standard	SAE J 518, ISO 6162-1
Material	Carbon Steel
Surface Finishing	Zinc/Nickel-Plating

Item No.	Designation	Hose Size			Connection Size		Hose Type	Working Pressure ( <sup>bar</sup> /PSI)	Dimensions (mm/in)					Weight ( <sup>kg</sup> /lbs) ca. per 100
		DN	Inch	Dash	Inch	Dash			D	D1	D2	X	L	
6100096121	HCS-12-SFL-08-M-W3	12	1/2	-8	1/2	-08	▲	345	9.5	13.0	30.2	45.5	81.0	11.7
								5000	.37	.51	1.19	1.79	3.19	25.80
6100096283	HCS-16-SFL-12-M-W3	16	5/8	-10	3/4	-12	▲	345	12.6	16.0	38.1	46.0	84.5	17.8
								5000	.50	.63	1.50	1.81	3.33	39.25
6100096449	HCS-19-SFL-12-M-W3	19	3/4	-12	3/4	-12	▲	345	14.8	19.1	38.1	46.5	92.5	21.2
								5000	.58	.75	1.50	1.83	3.64	46.75
6100096454	HCS-19-SFL-16-M-W3	19	3/4	-12	1	-16	▲	345	14.8	19.1	44.5	49.0	95.0	29.4
								5000	.58	.75	1.75	1.93	3.74	64.72
6100096598	HCS-25-SFL-16-M-W3	25	1	-16	1	-16	▲	345	20.0	25.9	44.5	48.0	103.0	32.9
								5000	.79	1.02	1.75	1.89	4.06	72.54
6100096603	HCS-25-SFL-20-M-W3	25	1	-16	1-1/4	-20	▲	345	20.0	25.9	50.8	68.0	123.5	49.0
								5000	.79	1.02	2.00	2.68	4.86	108.05
6100096730	HCS-31-SFL-20-M-W3	31	1-1/4	-20	1-1/4	-20	▲	272	26.0	32.5	50.8	69.5	129.5	49.9
								4000	1.02	1.28	2.00	2.74	5.10	110.03
6100096735	HCS-31-SFL-24-B-W3	31	1-1/4	-20	1-1/2	-24	▲	272	26.0	32.5	60.3	50.5	110.5	55.1
								4000	1.02	1.28	2.37	1.99	4.35	121.50
6100096807	HCS-38-SFL-20-B-W3	38	1-1/2	-24	1-1/4	-20	●	207	31.0	38.9	71.4	64.5	132.0	65.40
								3000	1.22	1.53	2.81	2.54	5.20	144.21
6100096812	HCS-38-SFL-24-M-W3	38	1-1/2	-24	1-1/2	-24	●	207	31.0	38.9	60.3	59.5	127.0	64.6
								3000	1.22	1.53	2.37	2.34	5.00	142.44
6100096817	HCS-38-SFL-32-B-W3	38	1-1/2	-24	2	-32	●	207	31.0	38.9	71.4	51.5	119.0	83.20
								3000	1.22	1.53	2.81	2.03	4.69	183.46
6100096863	HCS-51-SFL-24-B-W3	51	2	-32	1-1/2	-24	●	207	40.0	51.6	60.3	69.5	144.5	120.30
								3000	1.57	2.03	2.37	2.74	5.69	265.26
6100096870	HCS-51-SFL-32-M-W3	51	2	-32	2	-32	●	207	40.0	51.6	71.4	72.0	147.0	127.85
								3000	1.57	2.03	2.81	2.83	5.79	281.91

SFL - SAE Code 61 pressure rating are above standard ISO 6162-1:2002.



STAUFF SAE Flanges and Accessories





**Straight Insert with SAE Flange Adaptor  
Type SFS (6000 PSI Series)**

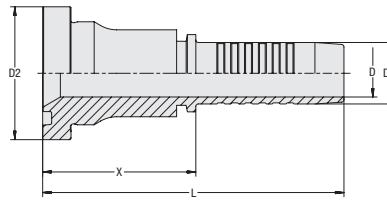

**Technical Features**

Suitable Hose Type	▲ 2SNK / ● 2SN
Connection Type	SAE Flange Adaptor
Sealing Type	O-Ring Face Seal (O-Ring not included in delivery.)
Standard	SAE J 518, ISO 6162-2
Material	Carbon Steel
Surface Finishing	Zinc/Nickel-Plating

Item No.	Designation	Hose Size			Connection Size		Hose Type	Working Pressure (bar/PSI)	Dimensions (mm/in)					Weight (lb) ca. per 100
		DN	Inch	Dash	Inch	Dash			D	D1	D2	X	L	
6100096133	HCS-12-SFS-08-M-W3	12	1/2	-08	1/2	-08	▲	413	9.5	13.0	31.8	45.5	81.0	11.3
								6000	.37	.51	1.25	1.79	3.19	24.92
6100096137	HCS-12-SFS-12-M-W3	12	1/2	-08	3/4	-12	▲	413	9.5	13.0	41.3	49.0	84.5	18.9
								6000	.37	.51	1.63	1.93	3.33	41.67
6100096293	HCS-16-SFS-08-M-W3	16	5/8	-10	1/2	-08	▲	413	12.6	16.0	31.8	51.5	90.0	13.4
								6000	.50	.63	1.25	2.03	3.54	29.55
6100096301	HCS-16-SFS-12-M-W3	16	5/8	-10	3/4	-12	▲	413	12.6	16.0	41.3	45.5	84.0	20.9
								6000	.50	.63	1.63	1.79	3.31	46.08
6100096305	HCS-16-SFS-16-M-W3	16	5/8	-10	1	-16	▲	413	12.6	16.0	47.6	46.5	85.0	25.9
								6000	.50	.63	1.87	1.83	3.35	57.11
6100096468	HCS-19-SFS-12-M-W3	19	3/4	-12	3/4	-12	▲	413	14.8	19.1	41.3	47.5	93.5	23.7
								6000	.58	.75	1.63	1.87	3.68	52.26
6100096476	HCS-19-SFS-16-M-W3	19	3/4	-12	1	-16	▲	413	14.8	19.1	47.6	50.0	96.0	32.8
								6000	.58	.75	1.87	1.97	3.78	72.32
6100096611	HCS-25-SFS-12-B-W3	25	1	-16	3/4	-12	▲	413	20.0	25.9	41.3	60.0	115.0	35.0
								6000	.79	1.02	1.63	2.36	4.53	77.18
6100096618	HCS-25-SFS-16-M-W3	25	1	-16	1	-16	▲	413	20.0	25.9	47.6	47.8	103.0	35.1
								6000	.79	1.02	1.87	1.88	4.06	77.40
6100096622	HCS-25-SFS-20-M-W3	25	1	-16	1-1/4	-20	▲	413	20.0	25.9	54.0	60.5	116.0	49.6
								6000	.79	1.02	2.13	2.38	4.57	109.37
2012031984	HCS-31-SFS-20-M-W3	31	1-1/4	-20	1-1/4	-20	▲	413	26.0	32.5	54.0	72.5	132.5	54.9
								6000	1.02	1.28	2.13	2.85	5.22	121.05
6100096826	HCS-38-SFS-24-M-W3	38	1-1/2	-24	1-1/2	-24	●	413	31.0	38.9	63.5	72.5	140.0	83.8
								6000	1.22	1.53	2.50	2.85	5.51	184.78
6100096876	HCS-51-SFS-32-M-W3	51	2	-32	2	-32	●	413	40.0	51.6	79.4	75.0	150.0	159.7
								6000	1.57	2.03	3.13	2.95	5.91	352.14



STAUFF SAE Flanges and Accessories

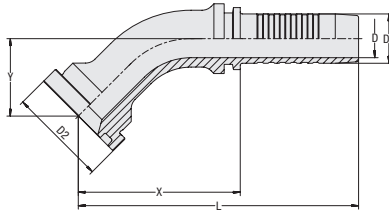

**45° Elbow Insert with SAE Flange Adaptor  
Type SFL 45° (3000 PSI Series)**

**Technical Features**

Suitable Hose Type	▲ 2SNK / ● 2SN
Connection Type	SAE Flange Adaptor
Sealing Type	O-Ring Face Seal (O-Ring not included in delivery.)
Standard	SAE J 518, ISO 6162-1
Material	Carbon Steel
Surface Finishing	Zinc/Nickel-Plating



Item No.	Designation	Hose Size			Connection Size		Hose Type	Working Pressure (bar/PSI)	Dimensions (mm/in)						Weight ( <sup>19</sup> lbs) ca. per 100
		DN	Inch	Dash	Inch	Dash			D	D1	D2	X	L	Y	
6100096117	HCS-12-SFL-08-045-M-W3	12	1/2	-08	1/2	-08	▲	345	9.5	13.0	30.2	50.0	85.5	20.5	10.6
								5000	.37	.51	1.19	1.97	3.37	.81	23.26
6100096123	HCS-12-SFL-12-045-M-W3	12	1/2	-08	3/4	-12	▲	345	9.5	13.0	38.1	55.0	90.5	26.0	15.7
								5000	.37	.51	1.50	2.17	3.56	1.02	34.62
6100096276	HCS-16-SFL-08-045-B-W3	16	5/8	-10	1/2	-08	▲	345	12.6	16.0	30.2	63.0	101.5	24.5	16.4
								5000	.50	.63	1.19	2.48	4.00	.96	36.05
6100096280	HCS-16-SFL-12-045-M-W3	16	5/8	-10	3/4	-12	▲	345	12.6	16.0	38.1	60.5	99.0	28.5	18.5
								5000	.50	.63	1.50	2.38	3.90	1.12	40.79
6100096445	HCS-19-SFL-12-045-M-W3	19	3/4	-12	3/4	-12	▲	345	14.8	19.1	38.1	62.5	108.5	30.0	22.3
								5000	.58	.75	1.50	2.46	4.27	1.18	49.17
6100096451	HCS-19-SFL-16-045-M-W3	19	3/4	-12	1	-16	▲	345	14.8	19.1	44.5	66.5	112.5	29.0	28.8
								5000	.58	.75	1.75	2.62	4.43	1.14	63.50
6100052710	HCS-25-SFL-16-045-M-W3	25	1	-16	1	-16	▲	345	20.0	25.9	44.5	82.5	137.5	35.0	40.7
								5000	.79	1.02	1.75	3.25	5.41	1.38	89.74
6100096600	HCS-25-SFL-20-045-M-W3	25	1	-16	1-1/4	-20	▲	345	20.0	25.9	50.8	92.5	147.5	37.5	48.5
								5000	.79	1.02	2.00	3.64	5.81	1.48	106.94
6100096723	HCS-31-SFL-16-045-B-W3	31	1-1/4	-20	1	-16	▲	272	26.0	32.5	44.5	81.5	141.5	30.5	55.6
								4000	1.02	1.28	1.75	3.21	5.57	1.20	122.60
6100096726	HCS-31-SFL-20-045-M-W3	31	1-1/4	-20	1-1/4	-20	▲	272	26.0	32.5	50.8	97.0	157.0	35.0	60.4
								4000	1.02	1.28	2.00	3.82	6.18	1.38	133.07
6100096732	HCS-31-SFL-24-045-B-W3	31	1-1/4	-20	1-1/2	-24	▲	272	26.0	32.5	60.3	102.5	162.5	40.0	75.4
								4000	1.02	1.28	2.37	4.04	6.40	1.57	166.15
6100096805	HCS-38-SFL-20-045-B-W3	38	1-1/2	-24	1-1/4	-20	●	207	31.0	38.9	50.8	101.5	169.0	39.0	81.1
								3000	1.22	1.53	2.00	4.00	6.65	1.54	178.72
6100096808	HCS-38-SFL-24-045-M-W3	38	1-1/2	-24	1-1/2	-24	●	207	31.0	38.9	60.3	127.5	195.0	44.0	105.5
								3000	1.22	1.53	2.37	5.02	7.68	1.73	232.52
6100096814	HCS-38-SFL-32-045-B-W3	38	1-1/2	-24	2	-32	●	207	31.0	38.9	71.4	113.0	180.5	44.5	110.75
								3000	1.22	1.53	2.81	4.45	7.11	1.75	244.20
6100096860	HCS-51-SFL-24-045-B-W3	51	2	-32	1-1/2	-24	●	207	40.0	51.6	60.3	116.0	191.5	44.0	142.50
								3000	1.57	2.03	2.37	4.57	7.54	1.73	314.21
6100096865	HCS-51-SFL-32-045-M-W3	51	2	-32	2	-32	●	207	40.0	51.6	71.4	149.0	224.0	67.0	173.20
								3000	1.57	2.03	2.81	5.87	8.82	2.64	381.91

Dimension Y ± 2.5 mm / .10 in

SFL - SAE Code 61 pressure rating are above standard ISO 6162-1:2002.



STAUFF SAE Flanges and Accessories



**45° Elbow Insert with SAE Flange Adaptor  
Type SFS 45° (6000 PSI Series)**

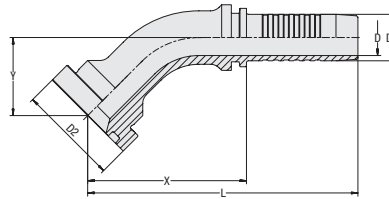

**Technical Features**

Suitable Hose Type	▲ 2SNK / ● 2SN
Connection Type	SAE Flange Adaptor
Sealing Type	O-Ring Face Seal (O-Ring not included in delivery.)
Standard	SAE J 518, ISO 6162-2
Material	Carbon Steel
Surface Finishing	Zinc/Nickel-Plating

Item No.	Designation	Hose Size			Connection Size		Hose Type	Working Pressure (bar/PSI)	Dimensions (mm/in)						Weight (kg/lbs) Ca. per 100
		DN	Inch	Dash	Inch	Dash			D	D1	D2	X	L	Y	
6100096129	HCS-12-SFS-08-045-M-W3	12	1/2	-08	1/2	-08	▲	413	9.5	13.0	31.8	45.5	81.0	23.0	11.5
								6000	.37	.51	1.25	1.79	3.19	.91	25.36
6100096135	HCS-12-SFS-12-045-M-W3	12	1/2	-08	3/4	-12	▲	413	9.5	13.0	41.3	55.0	90.5	27.0	18.0
								6000	.37	.51	1.63	2.17	3.56	1.06	39.69
6100096290	HCS-16-SFS-08-045-M-W3	16	5/8	-10	1/2	-08	▲	413	12.6	16.0	31.8	60.5	99.0	26.0	14.4
								6000	.50	.63	1.25	2.38	3.90	1.02	31.75
6100096295	HCS-16-SFS-12-045-M-W3	16	5/8	-10	3/4	-12	▲	413	12.6	16.0	41.3	60.5	99.0	28.0	20.3
								6000	.50	.63	1.63	2.38	3.90	1.10	44.76
6100096462	HCS-19-SFS-12-045-M-W3	19	3/4	-12	3/4	-12	▲	413	14.8	19.1	41.3	65.0	111.0	32.0	25.8
								6000	.58	.75	1.63	2.56	4.37	1.26	56.89
6100096471	HCS-19-SFS-16-045-M-W3	19	3/4	-12	1	-16	▲	413	14.8	19.1	47.6	64.2	114.0	30.5	32.3
								6000	.58	.75	1.87	2.53	4.49	1.20	71.22
6100096613	HCS-25-SFS-16-045-M-W3	25	1	-16	1	-16	▲	413	20.0	25.9	47.6	83.5	138.5	36.0	43.7
								6000	.79	1.02	1.87	3.29	5.45	1.42	96.36
6100096620	HCS-25-SFS-20-045-M-W3	25	1	-16	1-1/4	-20	▲	413	20.0	25.9	54.0	97.0	152.0	41.0	58.2
								6000	.79	1.02	2.13	3.82	5.98	1.61	128.33
6100096741	HCS-31-SFS-20-045-M-W3	31	1-1/4	-20	1-1/4	-20	▲	413	26.0	32.5	54.0	101.5	161.0	40.0	67.8
								6000	1.02	1.28	2.13	4.00	6.34	1.57	149.50
6100096822	HCS-38-SFS-24-045-M-W3	38	1-1/2	-24	1-1/2	-24	●	413	31.0	38.9	63.5	119.5	187.0	53.5	113.9
								6000	1.22	1.53	2.50	4.70	7.36	2.11	251.15
6100096872	HCS-51-SFS-32-045-M-W3	51	2	-32	2	-32	●	413	40.0	51.6	79.4	150.0	223.5	65.5	207.7
								6000	1.57	2.03	3.13	5.91	8.80	2.58	457.98

Dimension Y ± 2.5 mm / .10 in



STAUFF SAE Flanges and Accessories

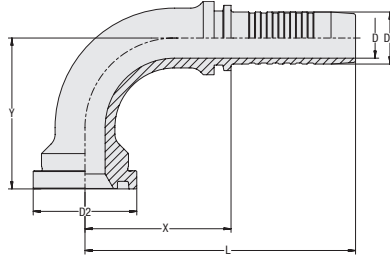

**90° Elbow Insert with SAE Flange Adaptor  
Type SFL 90° (3000 PSI Series)**

**Technical Features**

Suitable Hose Type	▲ 2SNK / ● 2SN
Connection Type	SAE Flange Adaptor
Sealing Type	O-Ring Face Seal (O-Ring not included in delivery.)
Standard	SAE J 518, ISO 6162-1
Material	Carbon Steel
Surface Finishing	Zinc/Nickel-Plating



Item No.	Designation	Hose Size			Connection Size		Hose Type	Working Pressure (bar/PSI)	Dimensions (mm/in)					Weight (kg/lbs) ca. per 100	
		DN	Inch	Dash	Inch	Dash			D	D1	D2	X	L		Y
6100096119	HCS-12-SFL-08-090-M-W3	12	1/2	-08	1/2	-08	▲	345	9.5	13.0	30.2	41.2	76.5	44.5	12.1
								5000	.37	.51	1.19	1.62	3.01	1.75	26.57
6100096125	HCS-12-SFL-12-090-M-W3	12	1/2	-08	3/4	-12	▲	345	9.5	13.0	38.1	40.7	76.0	50.5	17.1
								5000	.37	.51	1.50	1.60	2.99	1.99	37.60
6100096281	HCS-16-SFL-12-090-M-W3	16	5/8	-10	3/4	-12	▲	345	12.6	16.0	38.1	49.2	87.5	55.5	20.7
								5000	.50	.63	1.50	1.94	3.44	2.19	45.53
6100096286	HCS-16-SFL-16-090-B-W3	16	5/8	-10	1	-16	▲	345	12.6	16.0	44.5	61.5	100.0	58.0	34.7
								5000	.50	.63	1.75	2.42	3.94	2.28	76.51
6100096447	HCS-19-SFL-12-090-M-W3	19	3/4	-12	3/4	-12	▲	345	14.8	19.1	38.1	53.7	99.5	55.5	25.8
								5000	.58	.75	1.50	2.11	3.92	2.19	56.78
6100096452	HCS-19-SFL-16-090-M-W3	19	3/4	-12	1	-16	▲	345	14.8	19.1	44.5	66.0	112.0	61.5	34.7
								5000	.58	.75	1.75	2.60	4.41	2.42	76.51
6100096457	HCS-19-SFL-20-090-B-W3	19	3/4	-12	1-1/4	-20	▲	345	14.8	19.1	50.8	62.0	108.0	61.0	39.4
								5000	.58	.75	2.00	2.44	4.25	2.40	86.77
6100096596	HCS-25-SFL-16-090-M-W3	25	1	-16	1	-16	▲	345	20.0	25.9	44.5	70.0	125.0	72.0	47.4
								5000	.79	1.02	1.75	2.76	4.92	2.83	104.41
6100096601	HCS-25-SFL-20-090-M-W3	25	1	-16	1-1/4	-20	▲	345	20.0	25.9	50.8	82.0	137.0	79.0	58.0
								5000	.79	1.02	2.00	3.23	5.39	3.11	127.89
6100096606	HCS-25-SFL-24-090-B-W3	25	1	-16	1-1/2	-24	▲	345	20.0	25.9	60.3	73.0	128.0	69.0	65.9
								5000	.79	1.02	2.37	2.87	5.04	2.72	145.20
6100096724	HCS-31-SFL-16-090-B-W3	31	1-1/4	-20	1	-16	▲	272	26.0	32.5	44.5	75.5	135.5	68.0	63.4
								4000	1.02	1.28	1.75	2.97	5.33	2.68	139.69
6100096728	HCS-31-SFL-20-090-M-W3	31	1-1/4	-20	1-1/4	-20	▲	272	26.0	32.5	50.8	88.5	148.5	76.5	72.7
								4000	1.02	1.28	2.00	3.48	5.85	3.01	160.30
6100096733	HCS-31-SFL-24-090-B-W3	31	1-1/4	-20	1-1/2	-24	▲	272	26	32.5	60.3	93.5	153.5	87.0	87.9
								4000	1.02	1.28	2.37	3.68	6.04	3.43	193.82
6100096806	HCS-38-SFL-20-090-B-W3	38	1-1/2	-24	1-1/4	-20	●	207	31	38.9	50.8	93	161	86	93.6
								3000	1.22	1.53	2.00	3.66	6.34	3.39	206.39
6100096810	HCS-38-SFL-24-090-M-W3	38	1-1/2	-24	1-1/2	-24	●	207	31	38.9	60.3	116.0	178.5	110.0	130.8
								3000	1.22	1.53	2.37	4.57	7.03	4.33	288.41
6100096815	HCS-38-SFL-32-090-B-W3	38	1-1/2	-24	2	-32	●	207	31	38.9	71.4	103.5	171	98	127.35
								3000	1.22	1.53	2.81	4.07	6.73	3.86	280.81
6100096861	HCS-51-SFL-24-090-B-W3	51	2	-32	1-1/2	-24	●	207	40	51.6	60.3	107.5	182.5	97	159.1
								3000	1.57	2.03	2.37	4.23	7.19	3.82	350.82
6100096868	HCS-51-SFL-32-090-M-W3	51	2	-32	2	-32	●	207	40	51.6	71.4	127.5	200	140	205.8
								3000	1.57	2.03	2.81	5.02	7.87	5.51	453.79

Dimension Y ± 2.5 mm / .10 in

SFL - SAE Code 61 pressure rating are above standard ISO 61612-1:2002.



STAUFF SAE Flanges and Accessories



**90° Elbow Insert with SAE Flange Adaptor  
Type SFS 90° (6000 PSI Series)**

2SNK  
2SN

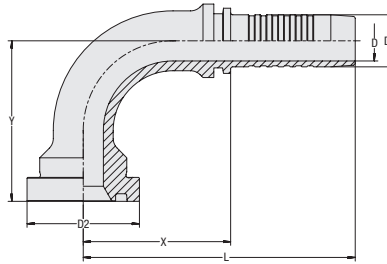

**Technical Features**

Suitable Hose Type	▲ 2SNK / ● 2SN
Connection Type	SAE Flange Adaptor
Sealing Type	O-Ring Face Seal (O-Ring not included in delivery.)
Standard	SAE J 518, ISO 6162-2
Material	Carbon Steel
Surface Finishing	Zinc/Nickel-Plating

Item No.	Designation	Hose Size			Connection Size		Hose Type	Working Pressure ( <sup>bar</sup> /PSI)	Dimensions (mm/in)						Weight ( <sup>kg</sup> /lbs) ca. per 100
		DN	Inch	Dash	Inch	Dash			D	D1	D2	X	L	Y	
6100096131	HCS-12-SFS-08-090-M-W3	12	1/2	-08	1/2	-08	▲	413	9.5	13.0	31.8	39.0	74.5	46.5	13.0
								6000	.37	.51	1.25	1.54	2.93	1.83	28.67
6100096136	HCS-12-SFS-12-090-M-W3	12	1/2	-08	3/4	-12	▲	413	9.5	13.0	41.3	43.2	78.5	50.0	20.8
								6000	.37	.51	1.63	1.70	3.09	1.97	45.86
6100096291	HCS-16-SFS-08-090-M-W3	16	5/8	-10	1/2	-08	▲	413	12.6	16.0	31.8	52.0	90.5	52.5	16.7
								6000	.50	.63	1.25	2.05	3.56	2.07	36.82
6100096297	HCS-16-SFS-12-090-M-W3	16	5/8	-10	3/4	-12	▲	413	12.6	16.0	41.3	47.5	86.0	57.0	23.2
								6000	.50	.63	1.63	1.87	3.39	2.24	51.16
6100096465	HCS-19-SFS-12-090-M-W3	19	3/4	-12	3/4	-12	▲	413	14.8	19.1	41.3	54.0	100.0	59.0	29.3
								6000	.58	.75	1.63	2.13	3.94	2.32	64.61
6100096474	HCS-19-SFS-16-090-M-W3	19	3/4	-12	1	-16	▲	413	14.8	19.1	47.6	61.5	107.5	68.0	38.2
								6000	.58	.75	1.87	2.42	4.23	2.68	84.23
6100096610	HCS-25-SFS-12-090-B-W3	25	1	-16	3/4	-12	▲	413	20.0	25.9	41.3	63.0	118.0	61.0	43.0
								6000	.79	1.02	1.63	2.48	4.65	2.40	94.82
6100096616	HCS-25-SFS-16-090-M-W3	25	1	-16	1	-16	▲	413	20.0	25.9	47.6	70.5	125.5	73.0	47.4
								6000	.79	1.02	1.87	2.78	4.94	2.87	104.52
6100096621	HCS-25-SFS-20-090-M-W3	25	1	-16	1-1/4	-20	▲	413	20.0	25.9	54.0	81.0	136.0	80.5	65.6
								6000	.79	1.02	2.13	3.19	5.35	3.17	144.65
2012031985	HCS-31-SFS-20-090-M-W3	31	1-1/4	-20	1-1/4	-20	▲	413	26.0	32.5	54.0	88.5	148.5	84.0	79.5
								6000	1.02	1.28	2.13	3.48	5.85	3.31	175.30
6100096820	HCS-38-SFS-20-090-B-W3	38	1-1/2	-24	1-1/4	-20	●	413	31.0	39.9	54.0	93.5	161.0	95.0	102.6
								6000	1.22	1.57	2.13	3.68	6.34	3.74	226.23
6100096824	HCS-38-SFS-24-090-M-W3	38	1-1/2	-24	1-1/2	-24	●	413	31.0	38.9	63.5	100.5	168.0	109.5	135.6
								6000	1.22	1.53	2.50	3.96	6.61	4.31	299.00
6100096874	HCS-51-SFS-32-090-M-W3	51	2	-32	2	-32	●	413	40.0	51.6	79.4	126.0	201.0	137.5	240.4
								6000	1.57	2.03	3.13	4.96	7.91	5.41	530.08

Dimension Y ± 2.5 mm / .10 in



STAUFF SAE Flanges and Accessories

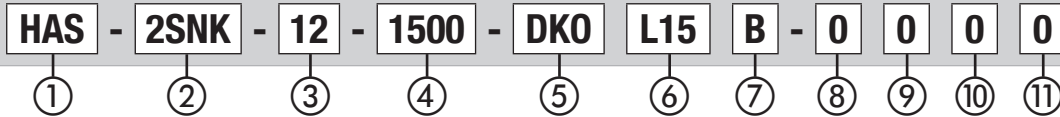

**Order Codes - Same Fitting Type and Connection Size**

**① Standard Hose Assembly**

 Hose Connector Standard **HAS**
**② Hose Type**

- ▲ Two High Tensile Steel Braid which exceeds EN 857 2SC - ISO 11237-1 2SC - SAE 100R16S **2SNK**
- Steel reinforced two wire braid hose with thin cover EN 853 2SN. SAE 1002AT - ISO 1436-1 2SN/2AT **2SN**

**③ Hose Size**

- ▲ 1/2" hose inside diameter **06**
- ▲ 3/8" hose inside diameter **10**
- ▲ 1/2" hose inside diameter **12**
- ▲ 5/8" hose inside diameter **16**
- ▲ 3/4" hose inside diameter **19**
- ▲ 1" hose inside diameter **25**
- ▲ 1-1/4" hose inside diameter **31**
- 1-1/2" hose inside diameter **38**
- 2" hose inside diameter **51**

**④ Assembly Length**

The length of the hose in mm measured to DIN 20066 (centres). Any hose longer than 99999 mm is classed as non standard. Maximum 5 digits. Refer to diagram below:

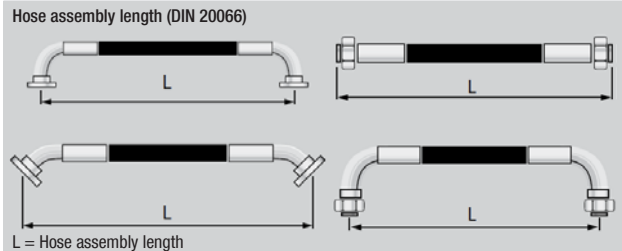
**⑤ Fitting Type**

- 24° Male cone metric external thread defined in L (Light) or in S (Heavy) EN8434-1 ISO17165 **CE**
- 24° Female cone O-Ring defined in L (Light) or in S (Heavy) EN8434-1 ISO17165 **DKO**
- 60° Male cone BSPP external thread EN8434-6 BS5200 **AGR**
- 60° Female cone BSPP nut thread EN8434-6 BS5200 **DKR**
- JIC 37° Male UN/ UNF external thread EN ISO 8434-2 SAE J514 **AGJ**
- JIC 37° Female cone UN/ UNF nut thread EN ISO8434-2 SAE J514 **DKJ**
- Female Flat sealing UN/UNF nut thread SAE J1453 **ORS**
- Flange Standard pressure SAE J518 (3000 PSI Series) **SFL**
- Flange High pressure SAE J518 (6000 PSI Series) **SFS**

**⑥ Connection Size**

- 1/4 (BSPP, BSPT, NPT) 7/16 (JIC, UNF) **04**
- 1/2 (JIC, UNF) **05**
- 3/8 (BSPP, BSPT, NPT) 9/16 (JIC, UNF) **06**
- 1/2 (BSPP, BSPT, NPT, SAE) 3/4 (JIC, UNF) **08**
- 5/8 (BSPP, BSPT, NPT) 7/8 (JIC, UNF) **10**
- 3/4 (BSPP, BSPT, NPT, SAE) 1-1/16 (JIC, UNF) **12**
- 1 (BSPP, BSPT, NPT, SAE) 1-5/16 (JIC, UNF) **16**
- 1-1/4 (BSPP, BSPT, NPT, SAE) 1-5/8 (JIC, UNF) **20**
- 1-1/2 (BSPP, BSPT, NPT, SAE) 1-7/8 (JIC, UNF) **24**
- 2 (BSPP, BSPT, NPT, SAE) 2-1/2 (JIC, UNF) **32**

**Metric Threads (DIN 2353 sizes)**

For Metric threads which are specified in L or S series, define Series and then size. Eg.L15  
**L Series:** 06, 08, 10, 12, 15, 18, 22, 28, 35, 42. **S Series:** 06, 08, 10, 12, 14, 16, 20, 25, 30, 38

**Metric Threads (non DIN sizes)**

For Metric threads which are not specified in L or S series, just define the Metric size and not the pitch size. E.g. M16x1.5 = M16

**⑦ Angle of Fitting**

- Straight Insert **(None)**
- 45 Degree Swept Angle Insert **A**
- 90 Degree Swept Angle Insert **B**

**⑧ Basic Material Of End Connections & Ferrules**

 carbon steel **0**
**⑨ Orientation Settings**

- in line (0 degrees) **0**
- 45 degree orientation **1**
- 90 degree orientation **2**
- 135 degree orientation **3**
- 180 degree orientation **4**
- 225 degree orientation **5**
- 270 degree orientation **6**
- 315 degree orientation **7**

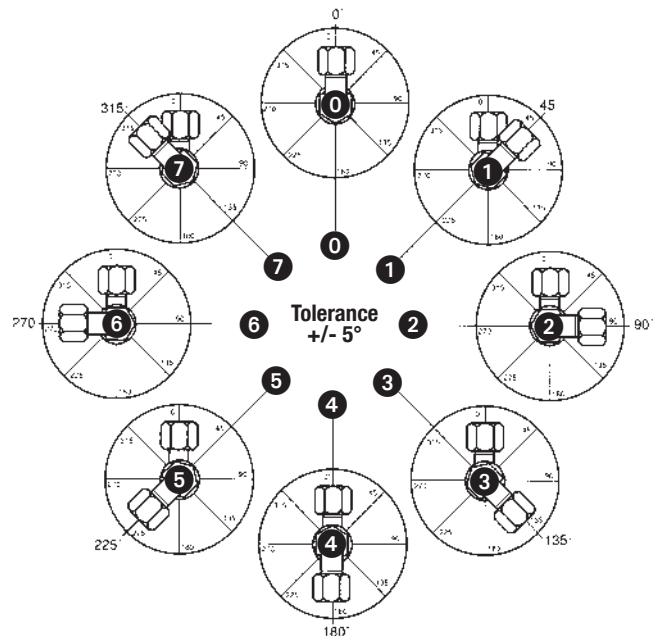
**⑩ Hose Protection**

- no hose protection **0**
- Spiral Hose Protector (HPR-SHP) **1**
- Hose Sleeve (HRP-SLE) (MSHA) **4**
- Hose Strip (HRP-STR) **8**
- Hose Velcro® Wrap (HRP-HVW) **9**

**⑪ Pressure Testing**

- no testing required **0**
- Pressure tested to country specific standard. Refer to Appendix. Supplied with certification **1**
- Air Pressure tested as per customer specification **2**
- Pressure tested (proof tested) to Mining Design Guidelines MDG41 (Australian standard for Mining Industry - Surface and Underground) **3**





Order Codes - Different Fitting Type and Connection Size - Hose End 1

2SNK  
2SN

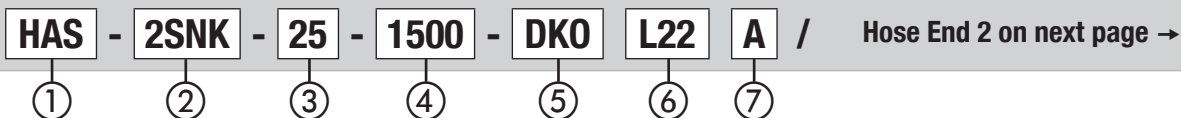

① Standard Hose Assembly

Hose Connector Standard	HAS
-------------------------	-----

② Hose Type

▲ Two High Tensile Steel Braid which exceeds EN 857 2SC - ISO 11237-1 2SC - SAE 100R16S	2SNK
● Steel reinforced two wire braid hose with thin cover EN 853 2SN. SAE 1002AT - ISO 1436-1 2SN/2AT	2SN

③ Hose Size

▲ 1/2" hose inside diameter	06
▲ 3/8" hose inside diameter	10
▲ 1/2" hose inside diameter	12
▲ 5/8" hose inside diameter	16
▲ 3/4" hose inside diameter	19
▲ 1" hose inside diameter	25
▲ 1-1/4" hose inside diameter	31
● 1-1/2" hose inside diameter	38
● 2" hose inside diameter	51

④ Assembly Length

The length of the hose in mm measured to DIN 20066 (centres). Any hose longer than 99999 mm is classed as non standard. Maximum 5 digits. Refer to diagram below:

Hose assembly length (DIN 20066)

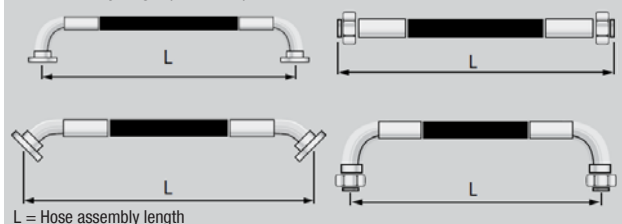

⑤ Fitting Type

24° Male cone metric external thread defined in L (Light) or in S (Heavy) EN8434-1 ISO17165	CE
24° Female cone O-Ring defined in L (Light) or in S (Heavy) EN8434-1 ISO17165	DKO
60° Male cone BSPP external thread EN8434-6 BS5200	AGR
60° Female cone BSPP nut thread EN8434-6 BS5200	DKR
JIC 37° Male UN/ UNF external thread EN ISO 8434-2 SAE J514	AGJ
JIC 37° Female cone UN/ UNF nut thread EN ISO8434-2 SAE J514	DKJ
Female Flat sealing UN/UNF nut thread SAE J1453	ORS
Flange Standard pressure SAE J518 (3000 PSI Series)	SFL
Flange High pressure SAE J518 (6000 PSI Series)	SFS

Note: Only define the second connection and size if different from the first connection

Order of definition of connections

If straight connection on both ends:

Define in the order of "Fitting Type" list. If the hose assembly has the same Fitting Type on both ends, define the smallest connection first.

If straight connection on one end and an angled connection on the other end:

Define the straight end connection first.

If angled connection on both ends:

Define in the order of "Fitting Type" list. If the hose assembly has the same Fitting Type on both ends, define the smallest connection first. If the connections are the same size, define in the order of "Angle of Fitting" list.

⑥ Connection Size

1/4 (BSPP, BSPT, NPT) 7/16 (JIC, UNF)	04
1/2 (JIC, UNF)	05
3/8 (BSPP, BSPT, NPT) 9/16 (JIC, UNF)	06
1/2 (BSPP, BSPT, NPT, SAE) 3/4 (JIC, UNF)	08
5/8 (BSPP, BSPT, NPT) 7/8 (JIC, UNF)	10
3/4 (BSPP, BSPT, NPT, SAE) 1-1/16 (JIC, UNF)	12
1 (BSPP, BSPT, NPT, SAE) 1-5/16 (JIC, UNF)	16
1-1/4 (BSPP, BSPT, NPT, SAE) 1-5/8 (JIC, UNF)	20
1-1/2 (BSPP, BSPT, NPT, SAE) 1-7/8 (JIC, UNF)	24
2 (BSPP, BSPT, NPT, SAE) 2-1/2 (JIC, UNF)	32

Metric Threads (DIN 2353 sizes)

For Metric threads which are specified in L or S series, define Series and then size. Eg. L22  
L Series: 06, 08, 10, 12, 15, 18, 22, 28, 35, 42. S Series: 06, 08, 10, 12, 14, 16, 20, 25, 30, 38

Metric Threads (non DIN sizes)

For Metric threads which are not specified in L or S series, just define the Metric size and not the pitch size. E.g. M16x1.5 = M16

⑦ Angle of Fitting

Straight Insert	(None)
45 Degree Swept Angle Insert	A
90 Degree Swept Angle Insert	B



**Order Codes - Different Fitting Type or/and Connection Size - Hose End 2**

← Hose End 1 on previous page

<b>SFL</b>	<b>16</b>	<b>A</b>	<b>-</b>	<b>0</b>	<b>0</b>	<b>0</b>	<b>0</b>
8	9	10		11	12	13	14

**⑧ Fitting Type**

24° Male cone metric external thread defined in L (Light) or in S (Heavy) EN8434-1 ISO17165	<b>CE</b>
24° Female cone O-Ring defined in L (Light) or in S (Heavy) EN8434-1 ISO17165	<b>DKO</b>
60° Male cone BSPP external thread EN8434-6 BS5200	<b>AGR</b>
60° Female cone BSPP nut thread EN8434-6 BS5200	<b>DKR</b>
JIC 37° Male UN/ UNF external thread EN ISO 8434-2 SAE J514	<b>AGJ</b>
JIC 37° Female cone UN/ UNF nut thread EN ISO8434-2 SAE J514	<b>DKJ</b>
Female Flat sealing UN/UNF nut thread SAE J1453	<b>ORS</b>
Flange Standard pressure SAE J518 (3000 PSI Series)	<b>SFL</b>
Flange High pressure SAE J518 (6000 PSI Series)	<b>SFS</b>

Note: Only define the second connection and size if different from the first connection

**Order of definition of connections** (see page 41 for diagrams)

**If straight connection on both ends:**

Define in the order of "Fitting Type" list. If the hose assembly has the same Fitting Type on both ends, define the smallest connection first.

**If straight connection on one end and an angled connection on the other end:**

Define the straight end connection first.

**If angled connection on both ends:**

Define in the order of "Fitting Type" list. If the hose assembly has the same Fitting Type on both ends, define the smallest connection first. If the connections are the same size, define in the order of "Angle of Fitting" list.

**⑨ Connection Size**

1/4 (BSPP, BSPT, NPT) 7/16 (JIC, UNF)	<b>04</b>
1/2 (JIC, UNF)	<b>05</b>
3/8 (BSPP, BSPT, NPT) 9/16 (JIC, UNF)	<b>06</b>
1/2 (BSPP, BSPT, NPT, SAE) 3/4 (JIC, UNF)	<b>08</b>
5/8 (BSPP, BSPT, NPT) 7/8 (JIC, UNF)	<b>10</b>
3/4 (BSPP, BSPT, NPT, SAE) 1-1/16 (JIC, UNF)	<b>12</b>
1 (BSPP, BSPT, NPT, SAE) 1-5/16 (JIC, UNF)	<b>16</b>
1-1/4 (BSPP, BSPT, NPT, SAE) 1-5/8 (JIC, UNF)	<b>20</b>
1-1/2 (BSPP, BSPT, NPT, SAE) 1-7/8 (JIC, UNF)	<b>24</b>
2 (BSPP, BSPT, NPT, SAE) 2-1/2 (JIC, UNF)	<b>32</b>

**Metric Threads (DIN 2353 sizes)**

For Metric threads which are specified in L or S series, define Series and then size. Eg.S16  
**L Series:** 06, 08, 10, 12, 15, 18, 22, 28, 35, 42. **S Series:** 06, 08, 10, 12, 14, 16, 20, 25, 30, 38

**Metric Threads (non DIN sizes)**

For Metric threads which are not specified in L or S series, just define the Metric size and not the pitch size. E.g. M16x1.5 = M16

**⑩ Angle of Fitting**

Straight Insert	<b>(None)</b>
45 Degree Swept Angle Insert	<b>A</b>
90 Degree Swept Angle Insert	<b>B</b>

**⑪ Basic Material Of End Connections & Ferrules**

carbon steel	<b>0</b>
--------------	----------

**⑫ Orientation Settings**

in line (0 degrees)	<b>0</b>	<b>0</b>
45 degree orientation	<b>1</b>	<b>1</b>
90 degree orientation	<b>2</b>	<b>2</b>
135 degree orientation	<b>3</b>	<b>3</b>
180 degree orientation	<b>4</b>	<b>4</b>
225 degree orientation	<b>5</b>	<b>5</b>
270 degree orientation	<b>6</b>	<b>6</b>
315 degree orientation	<b>7</b>	<b>7</b>

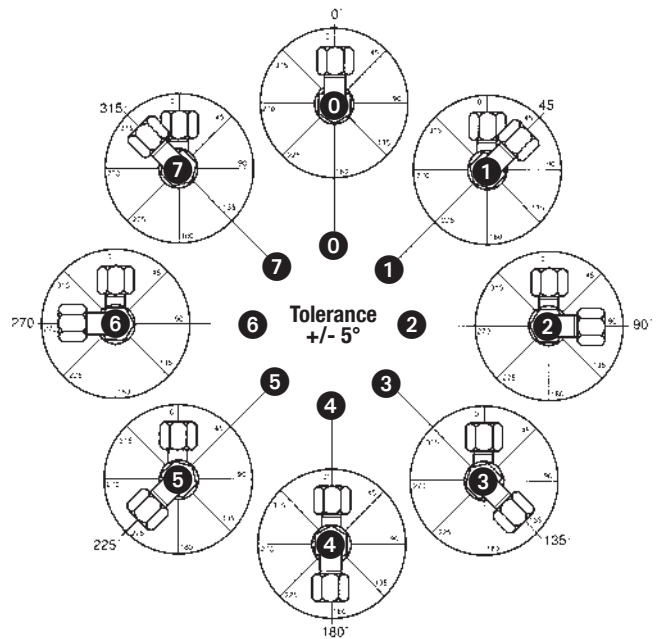
**⑬ Hose Protection**

no hose protection	<b>0</b>
Spiral Hose Protector (HPR-SHP)	<b>1</b>
Hose Sleeve (HRP-SLE) (MSHA)	<b>4</b>
Hose Strip (HRP-STR)	<b>8</b>
Hose Velcro® Wrap (HRP-HVW)	<b>9</b>

**⑭ Pressure Testing**

no testing required	<b>0</b>
Pressure tested to country specific standard. Refer to Appendix. Supplied with certification	<b>1</b>
Air Pressure tested as per customer specification	<b>2</b>
Pressure tested (proof tested) to Mining Design Guidelines MDG41 (Australian standard for Mining Industry - Surface and Underground)	<b>3</b>

